

Plastic Vent Grilles

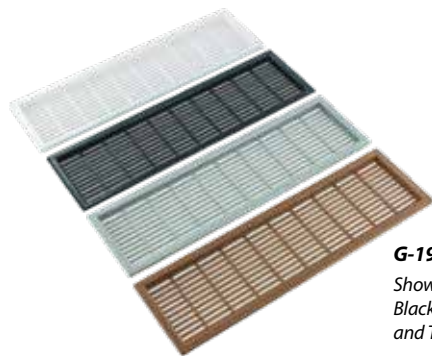

G-1970-*

Shown in White,
Black, Silver Gray
and Tan

Material: Styrene
Available in ***White (WH)**, ***Black (BK)**,
***Silver Gray (SG)** or ***Tan (TN)**

Designed to provide air circulation where needed

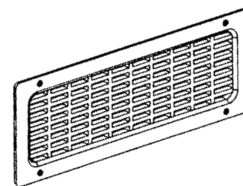

G-1971-*
Screw Mount

Part #	Overall Size	Hole Size	Mounting Type
G-1970-*	2-5/8" x 8-7/8"	2-3/8" x 8-5/8"	Glue On
G-1971-*	3-9/16" x 9-11/16"	2-5/8" x 8-31/32"	Screw Mount
G-1972-*	3-9/16" x 9-11/16"	2-5/8" x 8-31/32"	Glue On
G-1975-*	2-7/8" x 8-3/4"	2-7/16" x 8-3/8"	Glue On

■ - Not available in White

Round Plastic Vents



Material: Styrene

Available in ***White (WH)**, ***Black (BK)**, or ***Silver (SG)**

Designed to provide air circulation where needed

Part #	Overall Dia.	Drill Hole Dia.	Height
G-200-*	2-3/8"	2"	5/8"
G-250-*	2-11/16"	2-1/2"	3/4"
G-300-*	3-3/8"	3"	3/4"

SUGATSUNE

Round



Part #	O.D.	I.D.	Thickness
SAM-45	1.8125	1.641"	.2047"
SAM-60	2.359	2.109"	.2362"
SAM-85	3-344	3.062"	0.2441"

Material: 304 Stainless Steel
Satin finish

0.4 fine mesh wire diameter
Screws included

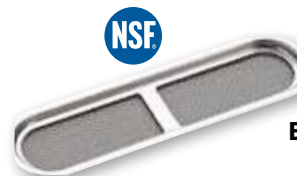

Elongated Oval

Part #	O.D.	I.D.	Thickness
SAD-150	5.906" x 1.578"	5.65" x 1.339"	0.2441"
SAD-200	7.891" x 1.969"	7.638" x 1.732"	0.2441"



Vents

SUGATSUNE

Material: 316 Stainless Steel
Satin finish

Screws not included



A



B



C



D

	Part #	Length	Width	Thickness
A	1-1122	8-15/32"	4-1/8"	.2362"
B	1-1212	4-17/32"	4-17/32"	.2362"
C	1-2211	8-15/32"	4-1/8"	.2362"
D	1-2222	8-15/32"	8-15/32"	.2362"

Industrial Vents

Locking Vented Hole Plugs

All available in Black, or add a "W" for White.



Part #	Hole Dia.	Maximum Thickness	A Head Dia.	B Thickness
MP-0750V	0.750"	0.125"	0.906"	0.406"
MP-0875V	0.875"	0.125"	1.1016"	0.453"

REMOVABLE VENTED NYLON PLUGS AVAILABLE, PLEASE INQUIRE!



Phone: 1-800-631-8375 • Fax: 1-800-888-3315

Adjustable Panel / Glass Retainer



SOLD IN SETS

Part #
6500-*

Lengths: 12 Ft.
Material: RPVC
Accommodates all panels at 1/16", 1/8" & 1/4"

Colors Available

***LB** - Light Beige ***FW** - Frosty White ***PLT** - Platinum
unless otherwise noted

Insert May Be:

- Glass • Markerboard • Tackboard
- Expanded Metal Grilles
- Woven Wire Grilles
- Decorative MDF Screening Panel

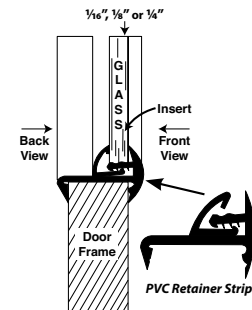
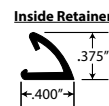
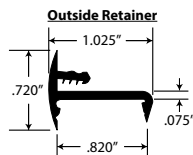

Panel Retainer

Lengths: 100 Ft. / 500 Ft. Coils

Material: Vinyl

Colors Available

***WH** - White ***BK** - Black ***BR** - Brown
unless otherwise noted

Staple Type

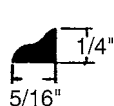
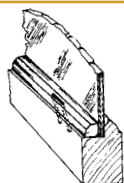

Part #
102-625-*

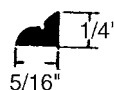

Part #
102-680-*

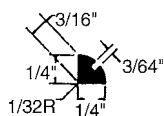

Part #
102-627-*

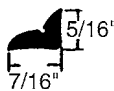

Part #
102-681-*

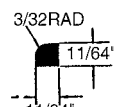

Part #
102-645-*
White not available

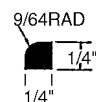

Part #
102-698-*

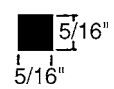

Part #
102-644-*

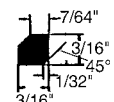

Part #
102-778-*



Part #
102-623-*

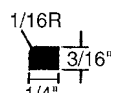

Part #
102-624-*

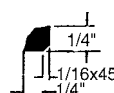

Part #
102-620-*
White not available

Lengths: 100 Ft. / 500 Ft. Coils
Material: Vinyl • **Use S4 or S10 Slotter**

Colors Available

***WH** - White ***BK** - Black
***BR** - Brown ***CL** - Clear
unless otherwise noted

Groove Type

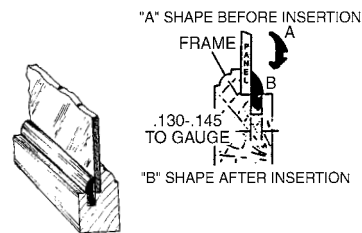

Part #
102-621-*
Also Available In Fruitwood & Red

Mirror Clip

Designed to attach mirrors, glass, decorative panels, etc. to any flat surface

Clear

- Made of crystal styrene, ribbed
- Fits 1/4" glass thickness

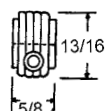

Use a #5
Flat head screw
(Sold separately)

Part #

R45-293CL

FLAT HEAD ZINC SCREWS

Part #

SCR-5625FHZ #5 x 5/8"

Flush

- Retainers are **P.E. plastic**. Clear retainers are **Lexan plastic**
- Screws sold separately

R21-10

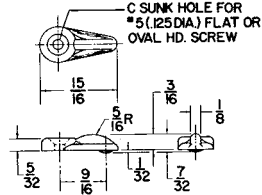

R21-180

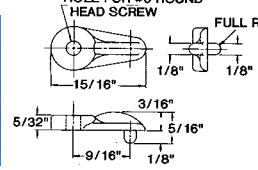

R21-183

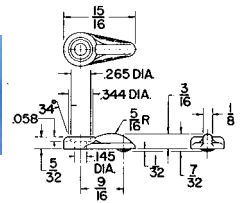

Part #	Color	Use Screw
R21-10BE	Beige	A
R21-10BK	Black	A
R21-10CL	Clear	A
R21-180CL	Clear	B
R21-183BE	Beige	C

R21 Series Screws

Screw Part #	Head/Finish
A SCR-5625FHZ	#5 x 5/8" Flat Head Zinc
B SCR-6625PHZ	#6 x 5/8" Pan Head Zinc
C SCR-6625FHZ	#6 x 5/8" Flat Head Zinc

Recessed

- Retainers are **P.E. plastic**. Clear retainers are **Lexan plastic**
- They are for semi-permanent installations
- Screws sold separately

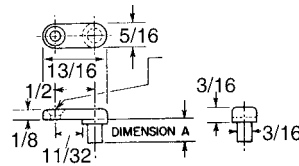

Part #	Color	Dim. "A"	Use Screw
R21-281DB	Dk. Brown	5/16"	C
R21-281CL	Clear	5/16"	C
R21-313CL	Clear	1/8"	C

Grille



BRONZE FINISH ON STEEL Overall Size: 3/8" wide x 1-3/16" long screws included.

- Screw adjustable, secure holding & quick removal of metal grilles.
- Reversible to accommodate varied glass thicknesses and door mortises.
- 7/8" vinyl tipped screw tightens and adjusts without harming glass.

Part #
SH-302



No-Route Glass / Panel Retaining Clips

- **Color:** Brown
- Designed to attach glass or decorative panels to doors without routing
- Can be screwed or stapled into place
- Available for 1/8" or 3/16" thick panels



R21-1804BR



R21-1805BR

Part #	Material Thickness	Type
R21-1804BR	1/8"	Corner
R21-1805BR	3/16"	Corner

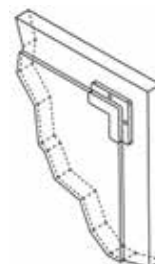

Fast Cap® Self Adhesive Cover Caps



- 9/16" (14mm) and 11/16" (18mm) Diameter
- Available in solid color PVC, PVC wood grain, PVC metallic, Unfinished solid wood and Finished solid wood.
- Unlike other caps, these do not depend on the screw for proper installation
- Does not require any additional gluing or caulking

11/16"

(actual sizes)

9/16"

STANDARD

9/16" PVC: 20 Sheets with 53 caps ea.
1060 per box

9/16" Wood: 20 Sheets with 52 caps ea.
1040 per box

11/16": 20 Sheets with 36 caps ea.
720 caps per box

Part#	Size
PVC Solid Colors	
FCSP916-	9/16"
FCSP1116-	11/16"
PVC Wood Colors	
FCWP916-	9/16"
FCWP1116-	11/16"
PVC Metallic	
FCME916-	9/16"
FCME1116-	11/16"
Unfinished (Real Wood)	
FCSW916-	9/16"
FCSW1116-	11/16"
Prefinished (Real Wood)	
FCPW916-	9/16"
FCPW1116-	11/16"

PVC (Solids, Woodgrains and Metallics)

White (WH)	Medium Oak (MO)	Presidential Walnut (PW)	Select Cherry (SC)
Antique White (AW)	Light Oak (LO)	Imperial Walnut (IW)	Medium Cherry (MC)
Almond (AL)	Hardrock Maple (HM)	Mahogany on Walnut (MW)	Bourbon Cherry (BC)
Black (BK)	Manitoba Maple (MM)	Knotty Pine (KP)	Golden Cherry (GC)
Fog Gray (DG)	Light Maple (LM)	Beech (BE)	Dark Cherry (DC)
Folkstone Gray (LG)	Clear Maple (CM)	Brushed Brass (BR)	Heritage Cherry (HT)
Natural Oak (NO)	American Maple (AM)	Polished Brass (PBR)	Autumn Cherry (AC)
Golden Oak (GO)	Red Mahogany (RM)	Brushed Chrome (BCHR)	Fuji Cherry (FC)
Renaissance Oak (RN)	Dark Red Mahogany (DM)	Polished Chrome (PCHR)	Natural Cherry (NC)

MINI BOX

9/16" PVC: 5 Sheets with 53 caps ea.
265 per box

9/16" Wood: 5 Sheets with 52 caps ea.
260 per box

11/16": 5 Sheets with 36 caps ea.
180 caps per box

Part#	Size
FCMB916-	9/16"
FCMB1116-	11/16"

Unfinished (Real Wood)

Red Oak (RO)	Cherry (CH)	Sapele (SP)	Vg Fir (VF)	Walnut (WA)
White Oak (WO)	Mahogany (MG)	Pecan (PE)	Anigre (AN)	White Birch (WB)
Maple (MP)	Pine (PN)	Teak (TK)	Ash (AS)	Natural Birch (NB)
			Hickory (HC)	Alder (AR)

Pre-finished (Real Wood)

Ash (FAS)	Teak (FTK)	Red Oak (FRO)	Cherry (FCH)	Birch (FB)
Sapele (FSP)	Alder (FAR)	White Oak (FWO)	Mahogany (FMG)	Walnut (FWA)
		Maple (FMP)	Anigre (FAN)	Yellow Pine (FYP)

Flush Mount Drill Bit System



- Carbide tipped
- Allows user to drill a pilot hole and countersink
- The drill bits custom stop insures that the surface cannot be marred

Part #	Description
FCDB-0916-CB	9/16" Drill bit



Pop-On Screw Covers & Bases

MATERIAL: POLYPROPYLENE

Pop-On Screw Covers & Bases may be used with flat head nails, countersunk wood screws, self-tapping screws rivets, drive screws, machine screws, washer faced screws and other types of fasteners. They may also be used with metric screws in M4, M4.5 and M6 screw sizes.



POP-ON SCREW COVERS

■ **Green, Orange, Purple, Dark Blue, Light Pink, Forest Green, Turquoise, Yellow, Brown, Light Gray, and Beige** are available in SC2-250, **WHILE SUPPLIES LAST.**

Satin Chrome & Satin Copper available in all three sizes, **WHILE SUPPLIES LAST.**

Stock Colors & Metallics Available: Black, White, Brite Brass, Brite Chrome, Brite Copper.

• Polypropylene caps are UV stabilized for outdoor use (**does not** include metallics).

Cover#	Dimensions	
	A	B
SC2-460	.515	.215
SC2-810	.630	.225
■ SC2-250	.700	.260

Minimums Apply:
SC2-460CH, SC2-460COP
SC2-810BRS, SC2-810CH
Please Inquire

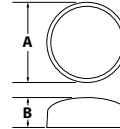

Works With Cover	Base #	A	B	C	D	Screw Size
SC2-460	SC2-B04P	.115	.415	.120	.275	#4 Pan
	SC2-B069	.115	.415	.151	.275	#6 Pan
	SC2-B46F	.115	.415	.151	-	#4/#6 Countersunk
SC2-810	SC2-B8P	.125	.505	.169	.365	#8 Pan
	SC2-B10P	.125	.505	.195	.365	#10 Pan
	SC2-B810F	.125	.505	.195	-	#8/#10 Countersunk
SC2-250	SC2-B250P	.125	.620	.245	.490	1/4-20 Pan
	SC2-B250F	.130	.620	.245	-	1/4-20 Countersunk

All Bases are a Natural Nylon Color

POP-ON SCREW BASES

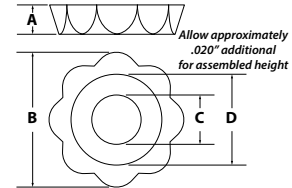

Screw Cover Caps

Standard Screw Cover Caps Only .50 in Diameter

WHILE SUPPLIES LAST

Part #	Color
SC-1DBR	Dk. Brown
SC-1BK	Black
SC-1AL	Almond
SC-1DG	Dove Gray

For PHILLIPS or POSI-DRIVE

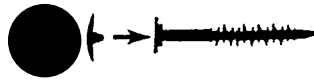

Petite Screw Cover Caps Only .40 in Diameter

WHILE SUPPLIES LAST

Part #	Color
SC-4BR	Brown
SC-4BE	Beige
SC-4LG	Light Gray

MATERIAL: POLYPROPYLENE

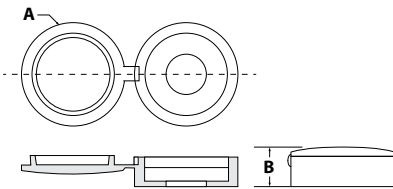

■ **WHILE SUPPLIES LAST**

Screw Plug Button

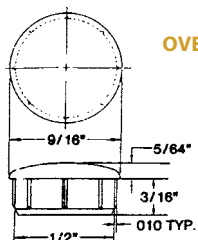

Part #	Color
R38-388BR	Brown

OVERHANGING HEAD
Polyethylene

Lexan & Butyrate Stem Bumpers

USES: DOORS, BOTTOM of FURNITURE, ETC.



* Pin Diameter
Tolerance = +/- .010

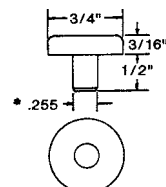

Part #	Material	Color
S49-750CL	Lexan	Clear
S49-750BK	Lexan	Black

SEALED MAGNETIC CATCHES



- Rare earth magnets
- Hermetically sealed for high corrosion resistance & eliminates metal particles
- No metal to metal contact, ideal for clean rooms
- Works with screw #8 (not included)

Polypropylene

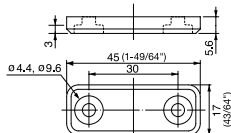

Part #	Magnetic Force	Color
MC-JM45WT	6.6 lbs.	White

Polyacetal

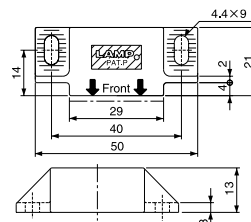

Part #	Magnetic Force	Color
MC-JM50/BL	6.6 lbs.	Black
MC-JM50/WT	6.6 lbs.	White

OPTIONAL STRIKE PLATES

- Hermetically Sealed
 - 304 Stainless Steel
- MC-JMP45
MC-JM49

Ultra Thin Magnetic Catch

Steel with Nickel finish 304 Stainless Steel

- Rare earth magnets
- Ideal for tight spaces
- Max temperature 176°F
- Strike plate included
- Screws included

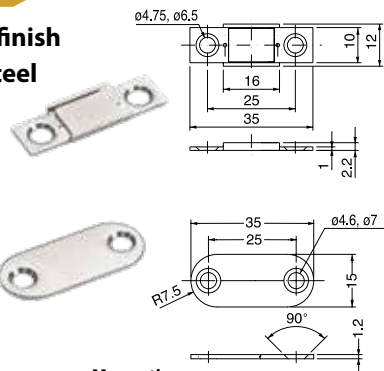

Part #	Description	Magnetic Force
MC-YN001P	Steel w/Nickel Finish	5.9 lbs.
MC-YN015SP	304 Stainless Steel	5.0 lbs.

Ultra Thin & Strong Magnetic Catch

Steel with Nickel finish

- Ideal for tight spaces with extra strong magnetic force
- Max temperature 176°F
- Works with screw #8 (not included)

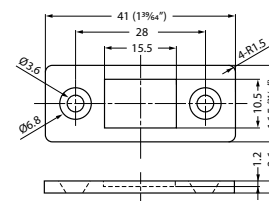

Part #	Description	Magnetic Force
MC-159	Catch	8.8 lbs.
MC-159-PLATE	Optional Strike Plate	n/a

Magnetic Touch Latches

ABS housing with Nickel plated steel strike plate

- For single or double doors
- For overlay door allow a 4mm (5/32") gap between door & cabinet frame for pushing room
- Screws included

SINGLE

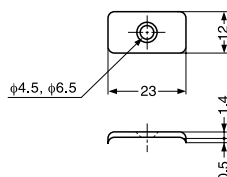

Part #	Color	Magnetic Force
ML-30S/BRN	Brown	2.6 lbs.
ML-30S/WHT	White	2.6 lbs.

DOUBLE

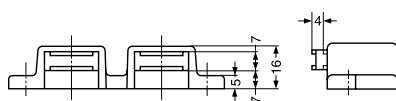

Part #	Color	Magnetic Force
ML-30W/BRN	Brown	2.6 lbs.
ML-30W/WHT	White	2.6 lbs.

Rectangular Magnetic Touch Latch

ABS housing with Zinc Chromate strike plate

- For overlay door allow a 3.5mm (9/64") gap between door and cabinet frame for pushing room.
- Screws included

SHORT

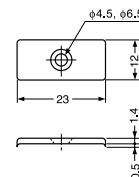

Part #	Color	Type	Magnetic Force
ML-80/BLK	Black	Short	3.5 lbs.
ML-80/BRN	Brown	Short	3.5 lbs.
ML-80/WHT	White	Short	3.5 lbs.

LONG

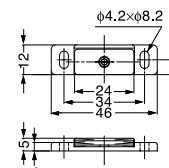

Part #	Color	Type	Magnetic Force
ML-120/BRN	Brown	Long	5.2 lbs.
ML-120/WHT	White	Long	5.2 lbs.

PLASTIC MAGNETIC CATCHES WITH STRIKE PLATE • MATERIAL: ABS (Unless noted)

MAG-CATCH™ 1 LB. PULL FORCE

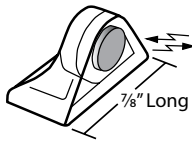

- Material: Acrylic DR101
- Size: 7/8" L x 1/2" H x 3/8" W
- Adhesive mount

Adhesive mount solvent bonds to acrylic, polycarbonate, ABS and styrene. Eliminates unsightly screws or hardware.

Part #	Color
MC-SM-CL	Clear

6.6 LB. PULL FORCE



- Size: 5/8" Dia. x 3/4" Long

Part #	Color
OI-132-BK	Black
OI-132-WH	White

Uses Screw
SCR-6625FHZ
#6 x 5/8" Flat Head Zinc

MAGNETIC PUSH LATCH 8 LB. PULL FORCE



- Size: 1-3/16" L x 1-7/8" W x 3/4" H
- Screws included

Part #	Color
OI-346	Black

8.8 LB. PULL FORCE



- Size: 2-1/4" L x 5/8" W x 1/2" H

Part #	Color
OI-121-BK	Black
OI-121-WH	White

Uses Screw
SCR-6625FHZ
#6 x 5/8" Flat Head Zinc

DOUBLE MAGNETIC TOUCH LATCH 9 LB. PULL FORCE



- Size: 2-3/8" L x 1-7/8" W x 3/4" H
- Screws & Strike Plate included

Part #	Color
OI-347	Black

10 LB. PULL FORCE

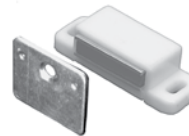

- Size: 1-13/16" L x 5/8" W x 1/2"
- Strike Plate Size: 1" x 7/8"
- Screws included

Part #	Color
OI-150-BK	Black
OI-150-BR	Brown
OI-150-WH	White

SUPER STRONG MAGNETIC CATCH 12 LB. PULL FORCE



- Size: 1-7/8" L x 15/16" W x 15/16" H

Part #	Color
OI-418	Brown

Uses Screw
SCR-6625FHZ
#6 x 5/8" Flat Head Zinc

26 LB. PULL FORCE



- Size: 3-3/8" L x 11/16" W x 9/16" H

Part #	Color
OI-312-BR	Brown

Uses Screw
SCR-6625FHZ
#6 x 5/8" Flat Head Zinc

ALUMINUM MAGNETIC CATCHES

WITH STRIKE PLATE

5 LB. PULL FORCE



- **HEAVY DUTY**
- Perfect for large cabinet doors
- Suitable for institutional or commercial cabinets
- Similar to EPCO #592
- Size: 2" L x 1-3/16" W x 13/16" H
- Screws Included

Part #
OI-332-AL

9 LB. PULL FORCE



- Size: 3-1/8" L x 1" W x 1/2" H
- Screws Included

Part #
OI-632-AL

14 LB. PULL FORCE



- Size: 3-1/8" L x 1" W x 3/4" H
- Screws Included

Part #
OI-732-AL

NON-MAGNETIC CATCHES

DOOR CATCH with Strike Plate



- Material: Clear Acrylic
- Size: 5/8" L x 1-5/16" W
- Adhesive mount

Part #
DC-100-CL

DOUBLE BARREL FRICTION CATCH with Strike Plate



- Material: White H.D.P.E.
- Size: 1-3/4" L x 9/16" W x 11/16" H

Uses Screw SCR-6625PHZ
#6 x 5/8" Pan Head Zinc

Part #
274-167

DOUBLE ROLLER CATCH with Self-Locating Strike Plate

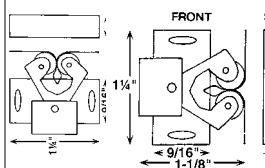

- Finishes: Antique Brass & Zinc
- Size: 1-3/4" L x 1-1/8" W x 1/2" H

Uses Screw
SCR-6625FHZ
#6 x 5/8" Flat Head Zinc

Part #	Finish
OI-781AB	Antique Brass
OI-781Z	Zinc

DOUBLE BALL CABINET CATCH Material: Solid Brass



Part #	Size	Finish
OI-881-BC	1-5/8"	Brass Plated
OI-882-BC	2"	Brass Plated
OI-884-BR	1-15-16"	Brass Plated
OI-884-NP	1-15-16"	Nickel Plated
OI-885-BR	2-3/8"	Brass Plated
OI-885-NP	2-3/8"	Nickel Plated



LATCH BODY

- Knob and latch combined
- Non-handed
- Low profile
- Use with door thickness 19/32" - 63/64"
- Provides 22 lbs. holding force
- Ideal for use in RV's and boats. Anywhere space is limited for application.
- Stainless Steel Screws included

Material: Zinc Alloy & ABS



OVAL

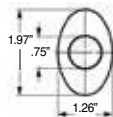

Part #	Finish
DPL-OV-G	Gold
DPL-OV-CR	Chrome



SQUARE

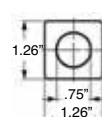

Part #	Finish
DPL-SQ-G	Gold
DPL-SQ-CR	Chrome
DPL-SQ-SN	Satin Nickel



ROUND



Part #	Finish
DPL-RO-G	Gold
DPL-RO-CR	Chrome

Non-Magnetic Latches & Catches

Non-Magnetic Touch Latches

Material: ABS Housing, Polyamide Catch Plate

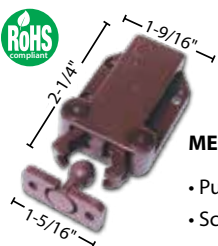

MEDIUM "Light Duty"

- Push to latch/unlatch
- Screws included

Part #	Color	Retaining Force
MC-37/BLK-1	Black	
MC-37/BRN-1	Brown	17.6 lbs.
MC-37/WHT-1	White	



- Push to latch/unlatch
- Screws included

Part #	Color	Retaining Force
MC-28/BLK	Black	6.6 lbs.



Material: Glass Filled Polyamide, PBT Body, Polyacetal Strike



- Long Stroke 40mm (1-9/16") for Large Doors
- Push to latch/unlatch
- Adjustable Strike Plate: Vertical +/-2, Horizontal +/-3.5mm
- Open/Close Cycle Test: 100,000 cycles

Part #	Color	Retaining Force	Push Out Force
MLC-100WT	White	20.2 lbs.	3.1 lbs.
MLC-100BL	Black		

Knuckle Catch

Material: Polyacetal Housing, Polyamide Catch Plate



- Grabs and holds door tightly

mounts with #4 screws (not included)

Part #	Color	Push In Force	Pulling Force
K-CATCH/WHT-T	White	12.5 lbs.	15.6 lbs.

All measurements are nominal

Tension Catches

Material: Stainless Steel • **Finish:** Polished

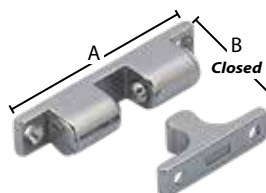

- 316 Stainless Steel catch for high corrosion resistance
- Tension force is not adjustable
- Stainless Steel Screws included

Part #	Push In Force	Pulling Force	Length A	Closed B
BCTS-40	4.4 lbs.	2.9 lbs.	1-11/16"	1/2"
BCTS-50	5.0 lbs.	3.9 lbs.	1-31/32"	5/8"
BCTS-70	12.5 lbs.	8.5 lbs.	2-3/4"	15/16"

Material: Zinc Alloy Steel • **Finish:** Chrome

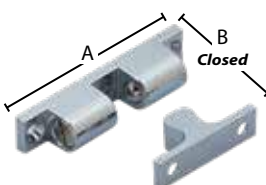

- Tension force is not adjustable
- Stainless Steel Screws included

Part #	Push In Force	Pulling Force	Length A	Closed B
BCT-40	9.7 lbs.	6.6 lbs.	1-43/64"	35/64"
BCT-50	9.0 lbs.	7.3 lbs.	1-31/32"	19/32"
BCT-70	10.1 lbs.	7.7 lbs.	2-3/4"	27/32"

Rotary Catch

Material: Polyacetal Catch & Strike, Polyethylene Roller



- Grabs and holds door tightly
- Screws not included

Part #	Color	Push In Force	Pulling Force	Length A	Closed B
6900/WHT	White	2.4 lbs.	3.5 lbs.	1-9/64"	7/8"
6901/WHT	White	4.8 lbs.	7 lbs.	1-15/64"	1-1/16"
6901/BRN	Brown				

Compression Draw Latches



Material: 304 Stainless Steel • **Finish:** Polished

- Spring loaded design compensates for tolerance and vibrations.
- Provides constant hold tension for secure latching.
- Screws not included



SCC-40/SS

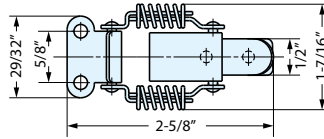

SCC-60/SS

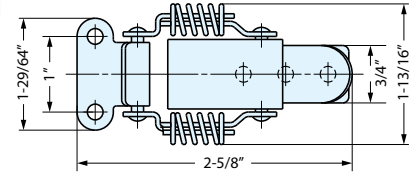

Part #	Load Capacity	Length	Width	Height
SCC-40/SS	24.2 lbs.	2-5/8"	1-7/16"	1/2"
SCC-60/SS	17.6 lbs.	3-5/8"	1-13/16"	1/2"

Draw Latch



Material: 304 Stainless Steel • **Finish:** Polished

- PS31A & PS30A designed for use with a padlock (not included).
- Screws not included



PS30A

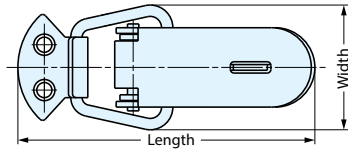

Part #	Description	Load Capacity	Length	Width	Height
PS31A	With	22 lbs.	2-1/2"	1-1/16"	9/16"
PS30A	Pad Lock Hole	33 lbs.	3-1/8"	1-1/4"	9/16"
PS31	Without	22 lbs.	2-9/16"	1"	3/8"
PS30	Pad Lock Hole	33 lbs.	3-1/8"	1-1/4"	1/2"

Stainless Steel Hasp

Material: 316 Stainless Steel • **Finish:** Electro Polished

- Stainless Steel Screws included

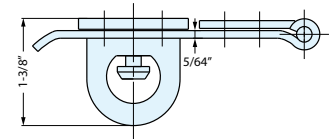
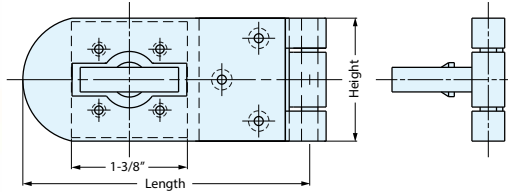

Part #	Length	Height
HP-635S	3-1/2"	1-1/2"
HP-645S	4-1/2"	1-1/2"
HP-660S	6"	2"

Spring Loaded Bar Latch



Material: 304 Stainless Steel • **Finish:** Polished

- Latch bolt snaps into the strike to prevent accidental release
- Push tab on strike to release
- Stainless Steel Screws included

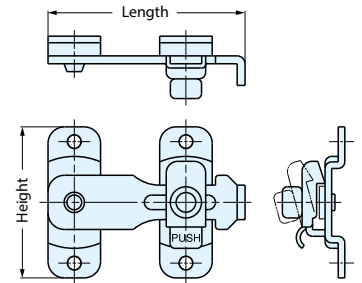
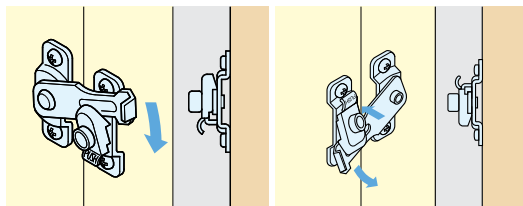

Part #	Length	Height
BLL-60	2-31/64"	1-13/16"
BLL-80	3-11/32"	2-9/16"
BLL-100	4-1/8"	3-5/32"

All measurements are nominal

Material: 304 Stainless Steel

- Stainless Steel Mortise, Surface Strike and Screws included

Finish: Satin

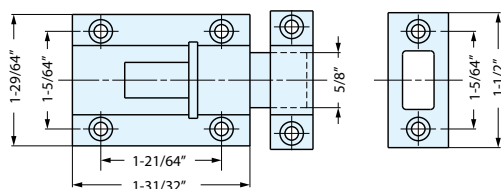

Part #	Length	Height
KR-50	1-31/32"	1-29/64"

Finish: Polished

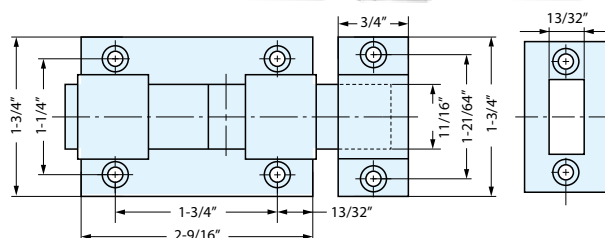

Part #	Length	Height
KR-65	2-9/16"	1-3/4"

Spring Loaded Barrel Bolts



Material: 304 Stainless Steel • **Finish:** Satin

- Knob springs back into sleeve to keep bolt in locked or unlocked position
- Stainless Steel Mortise, Surface Strike and Screws included

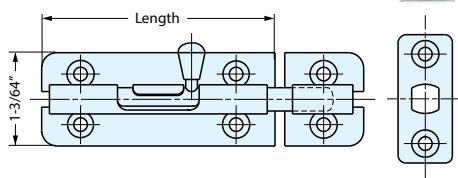

Part #	Length	Height
BL-40SS	1-37/64"	1-3/64"
BL-60SS	2-23/64"	1-3/64"

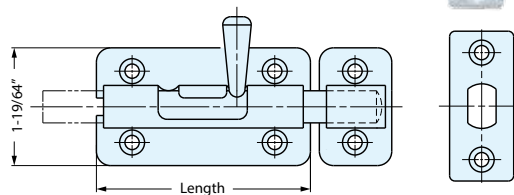

Part #	Length	Height
BLS-60	2-23/64"	1-19/64"
BLS-90	3-35/64"	1-19/64"

Gate Latch

Material: 304 Stainless Steel • **Finish:** Satin

- Gate latch with holes for padlock, (Padlock not supplied).
- Stainless Steel Screws included

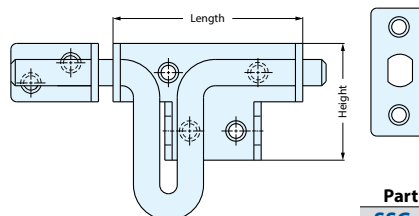

Part #	Length	Height
SSG-65	2-9/16"	1-37/64"
SSG-85	3-11/32"	1-13/16"

All measurements are nominal

Sliding Glass Door Lock

AL719-CHR-KA



- Material: Metal Construction
- Polished Chrome Finish
- Size: 1" Diameter x 3/8" Height
- Glass Thickness: 3/16" - 1/4"
- Keyed alike only

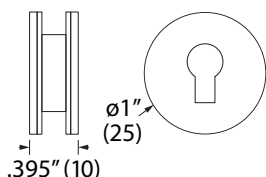

Cam Lock with Indicator

AL705-CHR-KA-L (Left)

AL705-CHR-KA-R (Right)



(Left)



(Right)

- Material: Metal Construction
- Polished Chrome Finish
- Size: 1-3/16" Long Cylinder - 3/4" hole required
- Lock Face: 15/16" Diameter
- For 15/16" Maximum Thickness
- Keyed alike only

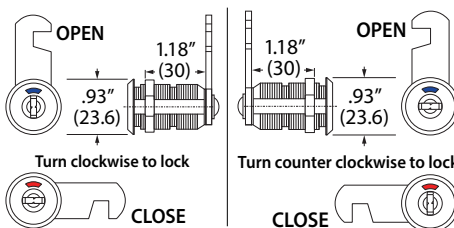

Spare Key: **KY-705**

No Bore Single Glass Door Lock

AL707-CHR-KA



- Material: Metal Construction
- Polished Chrome Finish
- Size: 1-13/32" Height x 1-1/4" Wide
- Glass Thickness: 3/16" - 1/4"
- Keyed alike only

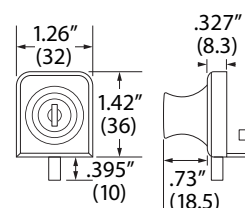

Spare Key: **KY-ALS**

No Bore Double Glass Door Lock

AL717-CHR-KA



- Material: Metal Construction
- Polished Chrome Finish
- Size: 1-13/32" Height x 2-1/16" Wide
- Glass Thickness: 3/16" - 1/4"
- Keyed alike only

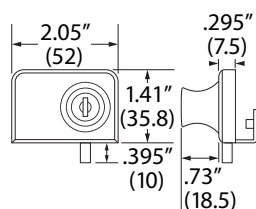

Spare Key: **KY-ALS**

No Bore Glass Door Lock

AL708-CHR-KA



- Material: Metal Construction
- Polished Chrome Finish
- Size: 1-13/32" Height x 1-1/4" Wide
- Glass Thickness: 3/16" - 1/4"
- Keyed alike only

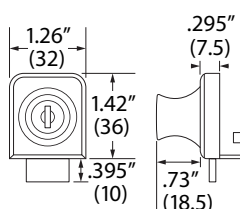

Spare Key: **KY-ALS**

Cam Lock

AL709-CHR-KA



- Material: Metal Construction
- Polished Chrome Finish
- Size: 3/4" Long Cylinder - 3/4" hole required
- Lock Face: 7/8" Diameter
- For 9/16" Max Thickness
- Keyed alike only

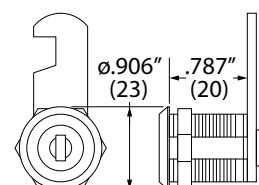

Spare Key: **KY-AL**

Drawer Lock AL711-CHR-KA



- Material: Metal Construction
- Polished Chrome Finish
- Size: 13/16" Cylinder Length - 1-1/2" CC
- Drawer Thickness: 7/8"
- Keyed alike only

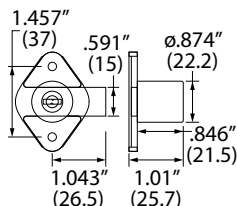

Spare Key: **KY-AL**



Sliding Glass Door Lock AL710-CHR-KA



- Material: Metal Construction
- Polished Chrome Finish
- Size: 7/8" Diameter - 5-1/4" Length
- Glass Thickness: 3/16"
- Keyed alike only

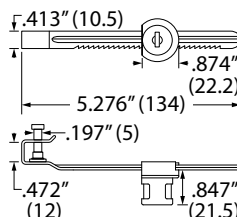

Spare Key: **KY-AL**



Mini Tubular Push Lock AL713-CHR-KA



- Material: Metal Construction
- Polished Chrome Finish
- Size: 1/2" Diameter x 3/16" Height
- Door Thickness: 3/8"
- Keyed alike only

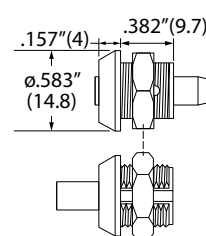

Spare Key: **KY-713**



Push Knob Latches

Knob & Latch Combined PL-B51-N



- Satin Nickel Finish
- Non-Handed
- For Door Thickness: 11/16" - 15/16"

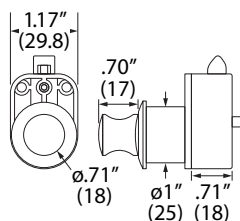

Hook Type Push Latch With Pull PL-B52-N



- Bright Nickel Finish
- Non-Handed
- For Door Thickness: 3/4"

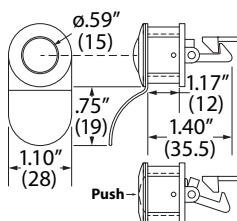

Push Lock With Spring Latch PL-B100-C



- Polished Chrome Finish
- Non-Handed
- Door Thickness: 19/32" - 1"

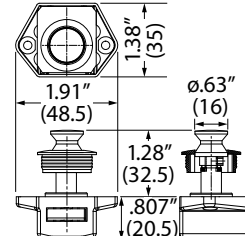

Plastic Hanging File Folder Mouldings

Lengths: 8 Ft.

Material: Styrene

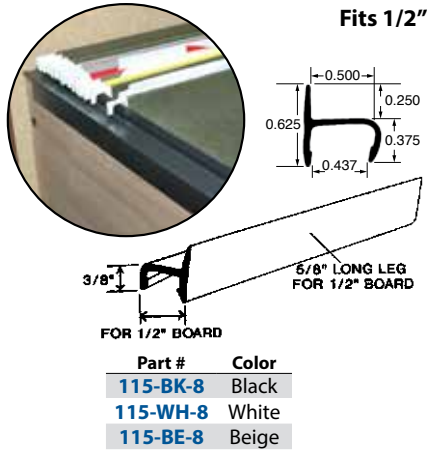

Fits 1/2"

115-2078-BK Fits 1/2"

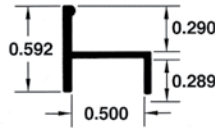

Material: Black Rigid PVC

115-2182-BK Fits 1/2"

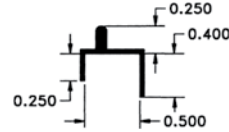

115-2180-BK Fits 5/8"

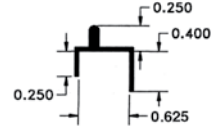

115-2132-BK Fits 1/2"

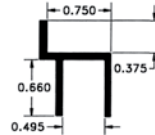

2132-CLIP

works with 115-2132-BK

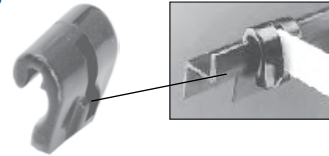

File Bar Holders

Material: Black Acetate

- Fits Up To 1/2" Thick Drawer Sides
- Holds 1/8" x 1/2" File Bar

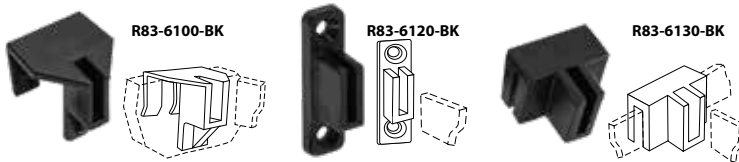

Part #	Description	Dimensions
R83-6100-BK	Hanging File Bar Holder	1-1/8" H x 15/16" W
R83-6120-BK	Screw Mount File Bar Holder	1-5/8" H x 1/2" W
R83-6130-BK	90° File Bar Holder	7/16" H x 15/16" W

Penda Flex Bar

Rectangular Bar

Material: Aluminum • **Lengths:** 8 Ft.

Finishes Available

*M - Mill - Dull Finish: As Extruded - May or May Not Have "Scratches"/Die Lines

*BK - Black - Powder Coated



Part #	A	B	Length
ALU599-18-*	1/2"	1/8"	120 Ft. 600 Ft.
ALU600-18-*	3/4"	1/8"	120 Ft. 600 Ft.

Drawer Locks

Drawer Lock For Wooden Doors



- Material: Zinc Alloy
- Polished Chrome finish
- Size: 3/4" Long cylinder
- DL-50711:** 1-1/2" x 1-1/2" x 1/4" thick
- DL-50822:** 1-1/2" x 2" x 1/4" thick
- Drawer Thickness: 20mm wooden drawer
- Keyed different
- Comes with 2 keys
- Use #5 wood screws, (Not included)

Part #	Size
DL-50711-CHR	1-1/2" x 1-1/2"
DL-50822-CHR	1-1/2" x 2"

Economy Push Lock For Sliding Cabinet Doors



- Material: Zinc Die Cast
- Polished Chrome finish
- Size: 7/8" Long cylinder x 3/4" Diameter
- Keyed alike only
- Comes with screws, cup strike & 2 keys

Part #
PL-5

Push Lock For Wooden Drawers



- Material: Zinc Alloy
- Size: 3/4" Hole required
Overall: 2" x 3/4" Long cylinder
- Drawer Thickness: 5/8" - 3/4"
- Keyed alike only
- Comes with 2 keys
- Use #5 wood screws, (Not included)

Part #	Color/Finish
PL-604-BK	Matte Black
PL-604-CHR	Polished Chrome

Combination Locks

4 Digit Combination Lock



- Material: Zinc and Plastic
- Nickel finish
- Size: 4-3/8" x 3-1/8"
- Drawer Thickness:
Up to 5/8" nominal
thick plate
- Comes with 2 keys
- Screws included

Part #
COM-LOK-DL01

Lock Aids

Deco-Hasp

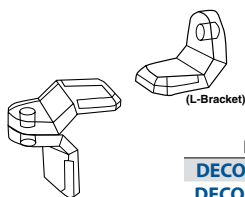

Material: Acrylic DR101 (Clear), ABS (Black)
Innovative locking hasp designed for corner or flat applications.
No moving parts reduce breakage in the field.
Solvent bonds to acrylic, polycarbonate, ABS and styrene.

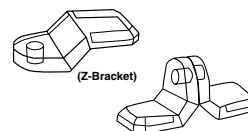

Part #	Description
DECO-HASP-LCL	Clear Acrylic 7/8" L x 3/4" W x 3/4" H Flat Mount Hasp
DECO-HASP-LBK	Black ABS 7/8" L x 3/4" W x 3/4" H Flat Mount Hasp
DECO-HASP-ZCL	Clear Acrylic 1-3/8" L x 3/4" W x 7/16" H Corner Mount Hasp
DECO-HASP-ZBK	Black ABS 1-3/8" L x 3/4" W x 7/16" H Corner Mount Hasp

Acrylic Hasp

- Color: Clear or Black
- 2-3/8" Long x 1-1/16" Wide x 1/8" Thick

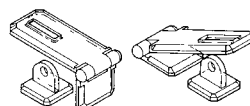

Bottom section of hasp is reversible for either corner or flat mounting.
Pre-determine assembly before inserting pin completely!

Part #	Color
HSP-110-CL	Clear
HSP-110-BK	Black

Double Door Latch System

Material/Color: Black ABS with Steel Pin

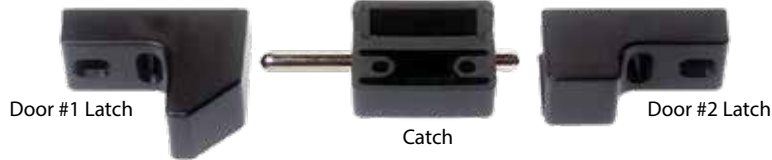

- Easy to Install
- Mounts with #4 x 3/4" flat head screws, sold separately



One-door lock (Installed on the #1 latch side) is used to secure both doors

Eliminates the need to reach inside the cabinet to release an elbow catch

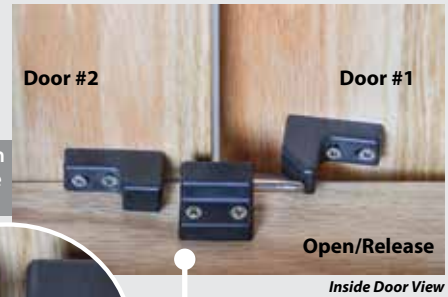

Pin locks Door #2 Latch when Door #1 is closed

Pin releases Door #2 Latch when Door #1 is opened

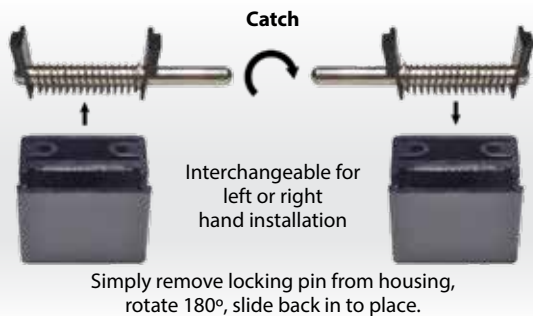

Interchangeable for left or right hand installation

Simply remove locking pin from housing, rotate 180°, slide back in to place.

Part #	Carton Quantity
AUTO-BOLT	100

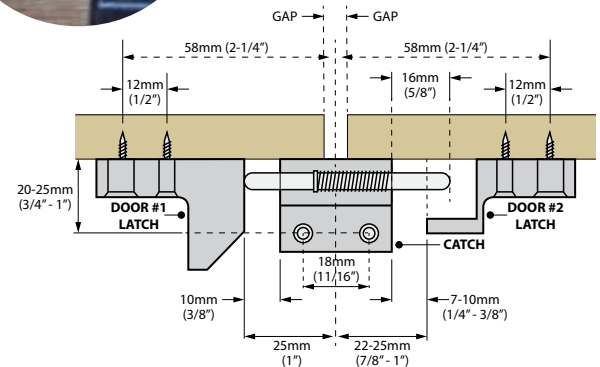

Rotor Hasp Locks

Material: ABS Knob with Zamak & Steel Lock Mechanism

- Ideal for personal storage security in the workplace and public locker rooms.
- Two finishes available to complement any decor
- Works with padlock hasp diameters from 4mm to 8mm
- Works with board thickness up to 22mm (0.866")



Padlock not included



Patented engineered break point. If any attempt is made to damage the lock, the mechanism will fix in the locked position to help prevent theft.

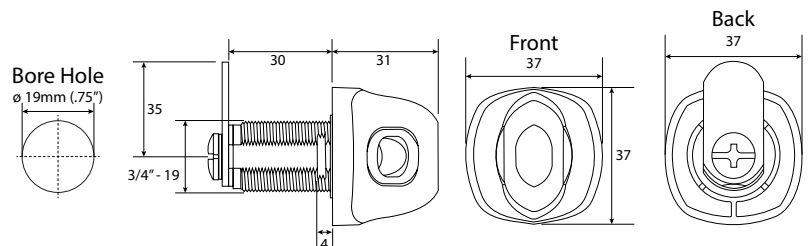

Part #	Finish	Carton Quantity
ROTO-HASP-BK	Black	50
ROTO-HASP-MC	Matte Chrome	50

Concealed Digital Lock For Cabinets

Invisible RFID Function Digital Lock For Cabinets

- **Material:** ABS Black Housing
- **Station Mode:** Repeated use with assigned programmed master or user RFID card
- **Door/Drawer Thickness:** 16~30mm (5/8" ~ 1-1/8")
- **Included for Installation:** 1 ABS striking plate, Steel plate to affix to back side, Set of screws
- **# of Users per Lock:** Can program 1 master and up to 50 user cards
- **RFID Range:** Must touch the card to cabinet
- **Level of Security:** Master card is used to create User card or bracelet



DGL-RF-CAB-BK

Easy programmability



Added Security - Cabinet does not appear locked from the naked eye

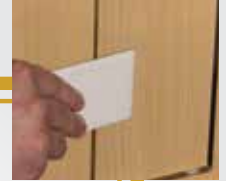

Cabinet locks without the visibility of a lock, providing a streamlined appearance



Battery Information

Battery Type	3 AAA (Not included)
Approximate Battery Life	4,000 times / 6 months (24,000 Cycles)
Low/Dead Battery	Low battery will beep several days before it stops working. When battery dies, the lock stays in the locked position.
Battery Back-up	Unlocks latch automatically when under low battery. Simply change battery for continuous function.
Tools required for Battery change	Easy installation of battery

See page G-18 for Accessories

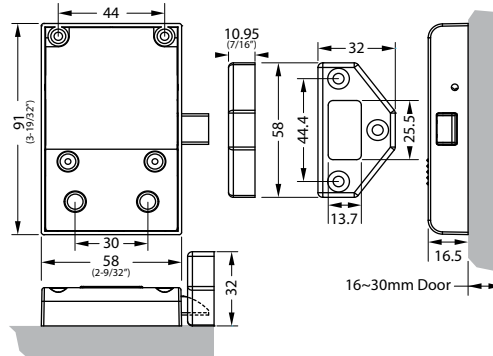

Concealed Digital Lock With Knob For Cabinets

Knob Style RFID Function Digital Lock For Cabinets

- **Material:** ABS Black Housing
ABS Matte Chrome Knob
- **Station Mode:** Repeated use with assigned programmed master or user RFID card
- **Door/Drawer Thickness:** 16~26mm (5/8" ~ 1")
- **Included for Installation:** 2 ABS striking plates, Steel plate to affix to back side, Set of screws
- **# of Users per Lock:** Can program 1 master and up to 50 user cards
- **RFID Range:** Must touch the card to knob
- **Level of Security:** Master card is used to create User card or bracelet



DGL-RF-KNOB-SL

Easy programmability



Added Security - Cabinet does not appear locked from the naked eye



Looks like an ordinary knob, but is actually the lock!



Battery Information

Battery Type	3 AAA (Not included)
Approximate Battery Life	4,000 times / 6 months (24,000 Cycles)
Low/Dead Battery	Low battery will beep several days before it stops working. When battery dies, the lock stays in the locked position.
Battery Back-up	Unlocks latch automatically when under low battery. Simply change battery for continuous function.
Tools required for Battery change	Easy installation of battery

See page G-18 for Accessories

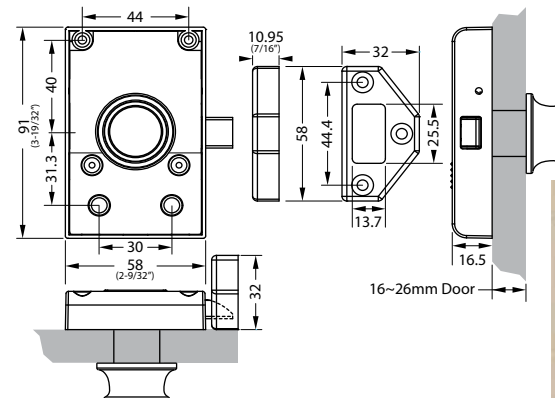

Concealed Digital Lock For Drawer Slides

Invisible RFID Function Digital Lock for Drawer Slides

- **Material:** ABS Black Housing
Zinc Alloy Receiver
- **Station Mode:** Repeated use with assigned programmed master or user RFID card
- **Door/Drawer Thickness:**
Works with 14", 16", 18", 20", 22"
Full Extension Drawer Slides
- **Included for Installation:**
Sensor area sticker,
1 ABS striking plate for auto open,
dead bolt for auto open,
set of screws
- **# of Users per Lock:** Can program 1 master
and up to 50 user cards
- **RFID Range:** Must touch the card to drawer
- **Level of Security:** Master card is used to
create User card or bracelet



Added Security - Cabinet does not appear locked from the naked eye



Touch card to drawer



Attaches to the drawer



Pops open when unlocked



Drawer opens
Pop-out distance approximately 4"



Push drawer to close/lock

Battery Information

Battery Type	3 AAA (Not included)
Approximate Battery Life	4,000 times / 6 months (24,000 Cycles)
Low/Dead Battery	Low battery will beep several days before it stops working. When battery dies, the lock stays in the locked position.
Battery Back-up	Unlocks latch automatically when under low battery. Simply change battery for continuous function.
Tools required for Battery change	Easy installation of battery

See below for Accessories

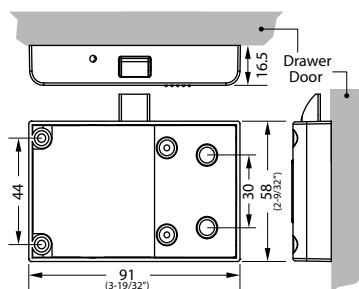
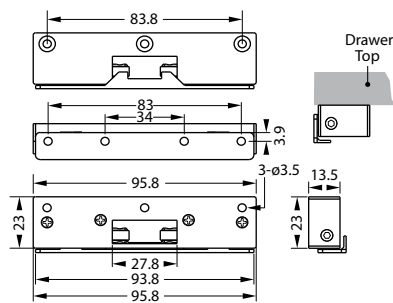

Full Extension Drawer Slides sold separately, see page H-44 for our OI-9500 Series

Drawer locks without the visibility of a lock, providing a streamlined appearance

Accessories For Concealed Digital Locks

RFID User Bracelets



RFID Cards



Part #	Description
DGL-RF-CD-M	RFID Master Card Blue
DGL-RF-CD-U	RFID User Card White

Digital Cabinet Lock

RFID & Keypad Function Digital Lock

- **Material:** ABS Black Housing
Zinc Alloy Silver Face
- **Station or Locker Mode Options...**
Station Mode is repeated use with the programmed master code, master fob, supervisor fob or user fob. Only the master code can make any changes to the stored master, supervisor or user fobs.
Locker Mode is a temporary one-time user code entered and changed per use.
- **Door/Drawer Thickness:**
13~24mm (1/2" ~ 15/16")
- **Install** as a new lock or retrofit over existing lock
- **# of Users per Lock:** 1 master code, 1 master fob, 1 supervisor fob, 5 user fobs
- **RFID Range:** Must touch fob onto lock
- **4 Levels of Security:** Master code, Master fob, Supervisor fob, User fob

Battery Information

Battery Type	4 x 1.5V AA Alkaline (Not included)
Approximate Battery Life	2,500 times / 6 months (15,000 Cycles)
Low/Dead Battery	Lock will signal low battery, with 100 openings remaining
Battery Back-up	9Volt can plug in front and charge the lock enough to open and change batteries
Tools required for Battery change	Use Phillips head screwdriver

See below for Accessories

DGL-RFKY-CAB-SL

Keypad & RFID Key technology

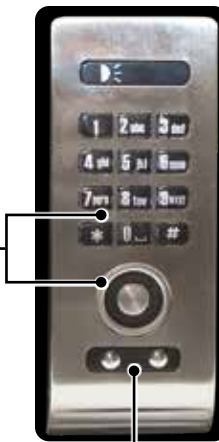

Battery easily recharged with 9Volt in front
Stays locked if battery dies

SLIM DESIGN



Touch fob to lock

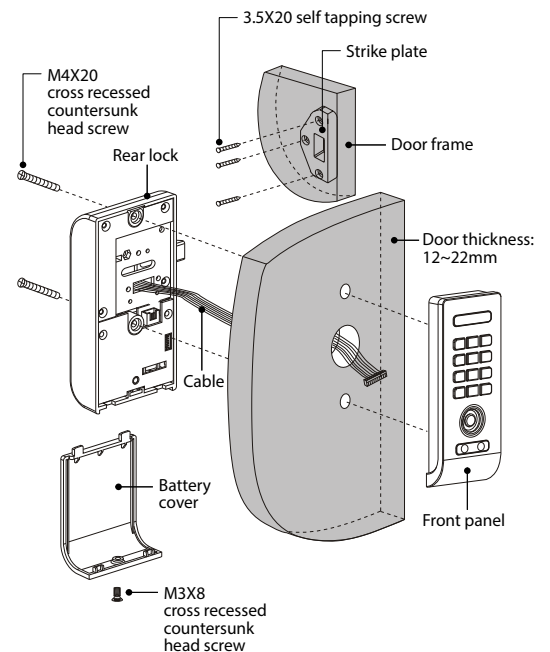
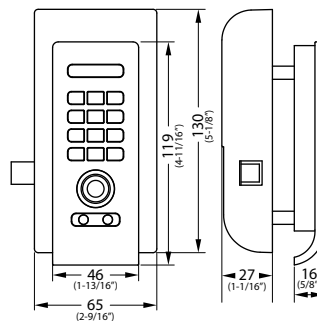

Accessories For Digital Cabinet Lock

RFID Fobs



Red

DGL-RF-FOB-RD

Master (Need)



Blue

DGL-RF-FOB-BL

Supervisor (Optional)

Digital Cam Lock

Keypad Function Digital Cam Lock

- **Material:** Zamac
- **Color:** Black or Silver
- **Station or Locker Mode Options...**
Station Mode is repeated use with the programmed master, supervisor or user codes. The master is set up first and has power to add or remove supervisor or user. Supervisor is set up next and can add/remove users.
Locker Mode is a temporary one-time user code entered and changed per use.
- **Door/Drawer Thickness:**
 3/8", 5/8", 7/8", 1-1/8"
- **# of Users per Lock:** 1 master, 1 supervisor, 1 user
- **Level of Security:** Master, Supervisor, User

Battery Information

Battery Type	20mm coin (Included)
Approximate Battery Life	3 to 5 years (50,000 Cycles)
Low/Dead Battery	Yellow low battery light will illuminate
Battery Back-up	Battery compartment on outside for easy replacement. No reset of codes required.
Tools required for Battery change	None. Slide out hidden battery compartment on side of lock.

The smallest fingerprint in the industry

DGL-KY-CAM

Shown: Black, Vertical Down

MOTORIZED LOCKING MECHANISM is immune to shock, vibration and magnetic fields.

Retrofits any cam lock with 3/4" DD hole

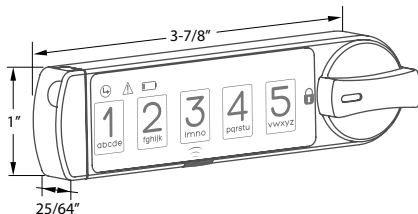

Shown: Silver, Horizontal Right

LOCK POSITION can be vertical right or left, or horizontal up or down, (as pictured).

90° or 180° Knob Rotation

Shown: Black, Horizontal Left

LATCHING MECHANISM supplied with **straight, offset cam sizes** 3/8", 5/8", 7/8" or 1-1/8".



Shown: Silver, Vertical Up



Part #	Color	Drawer Thickness	Keypad Configuration
DGL-KY-CAM-3BK-*	Black	3/8"	*HL Horizontal Left
DGL-KY-CAM-3SL-*	Silver	3/8"	
DGL-KY-CAM-5BK-*	Black	5/8"	*HR Horizontal Right
DGL-KY-CAM-5SL-*	Silver	5/8"	
DGL-KY-CAM-7BK-*	Black	7/8"	*VU Vertical Up
DGL-KY-CAM-7SL-*	Silver	7/8"	
DGL-KY-CAM-11BK-*	Black	1-1/8"	*VD Vertical Down
DGL-KY-CAM-11SL-*	Silver	1-1/8"	



DRAWER FRONT ADJUSTER

Material: Nylon



Part #	Color
6310-BR	Brown

- Use on drawer fronts to provide realignment facility on fronts attached to 4-sided drawers.
- Housing is nylon with die cast threaded insert screw, plated steel.
- Housing is hammer driven into a 25MM pre-bored hole.
- Screw attaches 4th side of drawer to allow adjustment of front until fully tightened.
- Screw size is 7/8" x 8/32".

Features:

- 2mm of adjustment in vertical or horizontal directions.
- 25mm hole boring in drawer front.
- Large head screw attachment to 4th side of drawer.
- Simple to use.

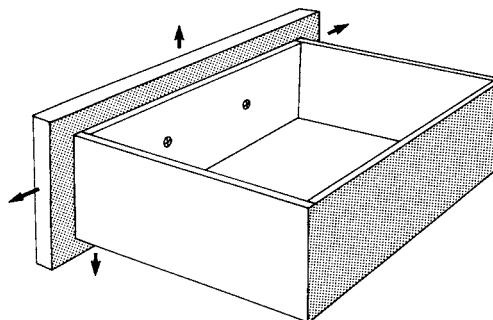
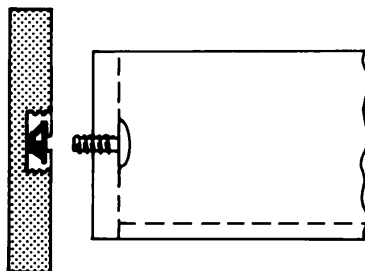

UNDER THE DESK STORAGE SOLUTIONS

- Pen/pencil compartments with plastic tray
- All mounting hardware included
- Made in the USA



- **Material:** High Impact Polystyrene
- Available in Black
- Contoured handle for easy access
- Designed to fit desks with shorter depth
- Narrow width
- Roller slide with plastic tray

Dimensions:
17.956"L x 12.75"W x 2.34"D

Part #	Color
PDN-1BK	Black



- **Material:** High Impact Polystyrene
- Available in Black
- Centrally located finger tab for easy opening
- Wide width
- Ball bearing slides

Dimensions:
19.19"L x 21.39"W x 2.05"D

Part #	Color
PDW-2BK	Black



- **Material:** Polypropylene
- Available in Black or Silver
- Narrow width
- Screw mount -Rotates
- Built-In tape dispenser

Dimensions:
13.625"L x 8.25"W x 1.375"D

Part #	Color
PDR-451-BK	Black
PDR-451-SL	Silver



- **Material:** High Impact Polystyrene
- Available in Black
- Ball bearing slides

Dimensions:
17.95"L x 12.75"W x 2.75"D

Part #	Color
PT-8931	Black

Keyboard Trays

- All mounting hardware included
- Made in the USA



- **Material:** High Impact Polystyrene
- Contoured wrist support
- Ball bearing slides

Dimensions:
18.23"L x 19.95"W x 3.90"D

Part #	Color
CT24-BK	Black



- **Material:** High Impact Polystyrene
- Pen/pencil storage
- Reversible mouse tray for right or left hand use
- Contoured wrist support
- Ball bearing slides

Dimensions:
18.20"L x 26.26"W x 3.90"D

Part #	Color
CT36-BK	Black

Material: Styrene

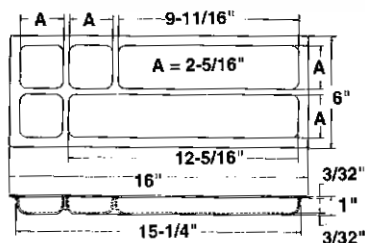

Part # Color
R11-82BK Black

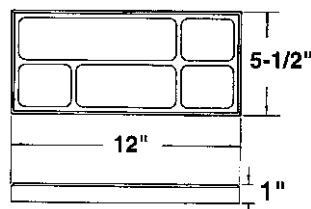

Part # Color
R11-90BK Black



HANGERS FOR
 R11-90 TRAYS

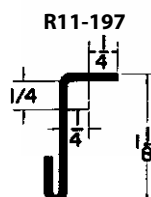
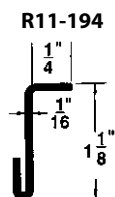

Part # Color
R11-194BK Black
R11-197BK Black

Insert Holder

- **Material:** ABS
- **Color:** Black
- 1/4" lip area
- Friction fit molded ribs
- Can be used as a cup holder or a paper clip holder.
- Other colors may be available. Minimums apply - please inquire.



36BKS



36BKD



Part # Drill Hole Diameter
36BKS 2-13/16"
36BKD 2-13/16"

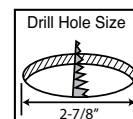

Drawer Essentials

DRAWER DIVIDERS

Material: Clear Polycarbonate

- Holds 1/2" material
- Can be screw mounted or applied with adhesive.

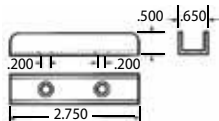

Part #	Color	Description
R83-941CL	Clear	Screw Mount
R83-941CL-A	Clear w/Adh	Adhesive

FLEXA-TOUCH™

Material: Natural ABS

- Designed to allow drawers to be opened just by pushing on the front
- Adjust for flush alignment from 7/8" to 3" max
- Screws included



Part #
OI-1021

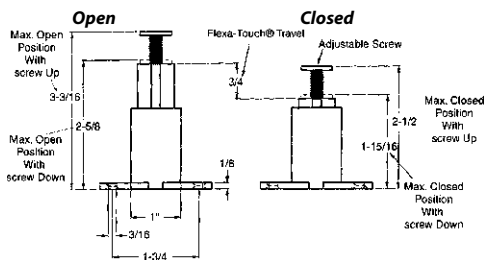

DRAWER BUMPERS

Material: Polyethylene

- Put bumpers on drawers to prevent damage to cabinet doors.
- Ideal for side mount slides



Part #	Color	Thickness
R51-DB51-WH	White	29/64" (11.5mm)
R51-DB51-BE	Beige	29/64" (11.5mm)
R51-DB18-WH	White	23/32" (18mm)
R51-DB18-BE	Beige	23/32" (18mm)

UNDERMOUNT ROLLOUT BUMPERS

Material: Polyethylene

- Ideally suited for use with drawers utilizing undermount slides.
- When used, will prevent damage to cabinet doors



Part #	Color
R51-C47-WH	White
R51-C47-BE	Beige

DRAWER DIVIDER CLIPS

Material: ABS

- Spring action design will securely hold divider panels up to 1/4" thick.

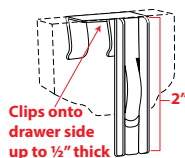

Part #	Color	Length
R83-6200-BK	Black	2-3/8" L

Corner Braces can be found on page G-44

DRAWER DIVIDER SUPPORTS

Material: Polyethylene

- Groove type - for 1/4" - 5/16" drawer dividers
- Supports are installed in grooves in drawer side
- Divider may be adjusted by removing it and relocating the supports

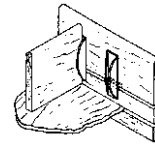
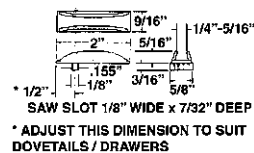

Part #	Color
R83-190BE	Beige

REMOVABLE DRAWER OUTSTOP

Material: Polypropylene

- Mount on back of drawer to prevent from pulling out
- Tip out stop forward to remove & upon reinsertion merely push the drawer all the way in & it will automatically snap into place.

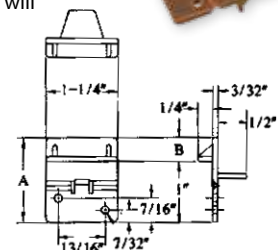
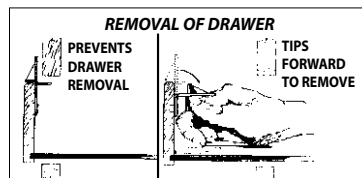

Part #	Color	A	B
R51-423BE	Beige	1-3/4"	3/4"
R51-424BE	Beige	2"	1"

Screw Part #

SCR-6500FHZ

#6 x 1/2" Flat Head Zinc

FALSE DRAWER FRONT CLIPS

- Used to attach finished fronts to cabinet that will have limited use
- Also, ideal for access panels that must be removable yet secure
- Use #6 screw x 1/2" (sold separately below)

Material: ABS

False Front Clip for 4-1/2" Opening

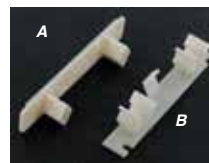
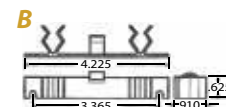
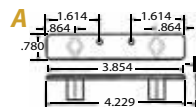

Part #	Color
FFDC-30	Natural

Material: Polycarbonate

False Front Clip with 1" Mounting Plate

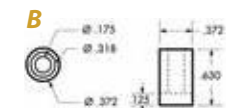
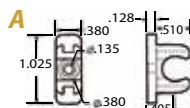

Part #	Color
FFDC-10	Clear

Screw Part #

SCR-8625FHZ

#8 x 5/8" Flat Head Zinc



OUR BINNING STRIP MAKES IT EASY TO ADJUST SPACING & ACCOMMODATE YOUR NEEDS

Material: Ivory, White, Black & Clear Styrene

Versatile plastic band strip can be installed on counters, tables, cabinets, in drawers - anywhere. Accepts various types of dividers. Economical yet easily installed.

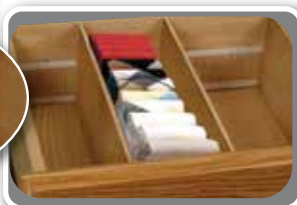

STANDARD BABY BINNING STRIP

FOR 1/4" DIVIDER

Works independently of standard binning strip

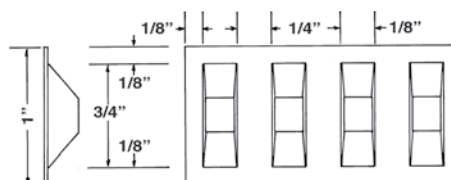

Part #	Description
292-BK-60	60"-Black-No adhesive
292-CL-60	60"-Clear-No adhesive
292-IV-60	60"-Ivory-No adhesive
292-WH-60	60"-White-No adhesive
292A-BK-60	60"-Black-w/adhesive
292A-CL-60	60"-Clear-w/adhesive
292A-IV-60	60"-Ivory-w/adhesive
292A-WH-60	60"-White-w/adhesive

STANDARD BINNING STRIP

FOR 1/4" DIVIDER

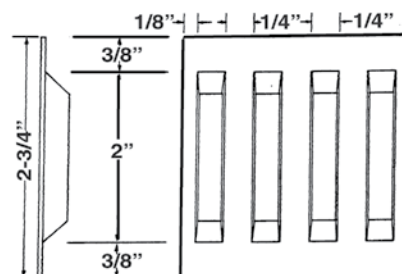
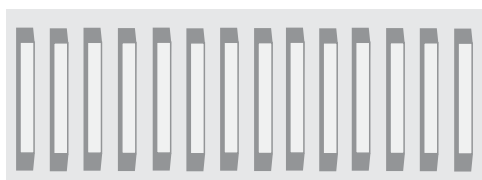

Part #	Description
282-CL-48	48"-Clear-No adhesive
282-CL-60	60"-Clear-No adhesive
282-IV-48	48"-Ivory-No adhesive
282-IV-60	60"-Ivory-No adhesive
282-WH-48	48"-White-No adhesive
282-WH-60	60"-White-No adhesive
282-BK-60	60"-Black-No adhesive
282A-CL-48	48"-Clear-w/adhesive
282A-CL-60	60"-Clear-w/adhesive
282A-IV-48	48"-Ivory-w/adhesive
282A-IV-60	60"-Ivory-w/adhesive
282A-WH-48	48"-White-w/adhesive
282A-BK-48	48"-Black-w/adhesive
282A-WH-60	60"-White-w/adhesive
282A-BK-60	60"-Black-w/adhesive

STANDARD BINNING STRIP

FOR 1/8" DIVIDER

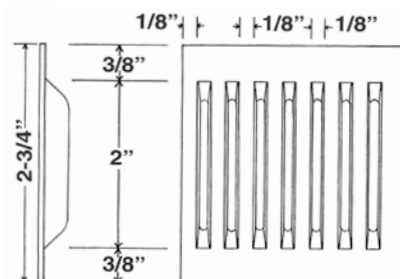
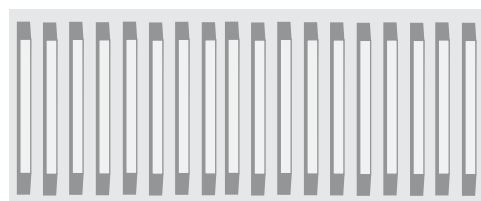

Part #	Description
182-CL-60	60"-Clear-No adhesive
182-IV-60	60"-Ivory-No adhesive
182-WH-60	60"-White-No adhesive
182-BK-60	60"-Black-No adhesive
182A-CL-60	60"-Clear-w/adhesive
182A-IV-60	60"-Ivory-w/adhesive
182A-WH-60	60"-White-w/adhesive
182A-BK-60	60"-Black-w/adhesive

Bump™'s products are made of durable, resilient polyurethane polymer formulated especially for its unique high coefficient of friction, slip-resistant, non-marring features. An aggressive, high tack pressure sensitive adhesive protected with any easy release liner makes application fast & easy. Use to prevent slamming, nicking, scuffing, sliding, vibration or noise. Clear bump™s become virtually invisible, since the clarity of the polyurethane bump™s enables them to transmit any color they are placed on.

• Non-skid • Non-marring • Crack resistant • Self adhesive backing

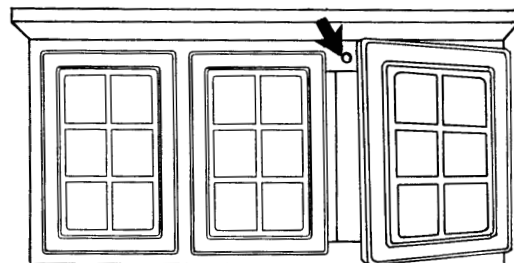

Clear

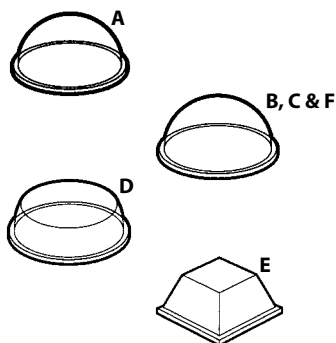

Dimensions:

Part #		English +/- 0.02 In.	Metric +/- 0.5 Mm	Style	Color
A SJ-5302	WIDTH: HEIGHT:	0.312 0.085	7.9 2.2	Bell Shaped	Clear
B SJ-5303	WIDTH: HEIGHT:	0.44 0.20	11.1 5.0	Hemisphere	Clear
C SJ-5306	WIDTH: HEIGHT:	0.375 0.150	9.5 3.8	Hemisphere	Clear
D SJ-5312	WIDTH: HEIGHT:	0.50 0.14	12.7 3.5	Cylindrical	Clear
E SJ-5318	WIDTH: HEIGHT:	0.50 0.23	12.7 5.8	Tapered Square	Clear
F SJ-5382	WIDTH: HEIGHT:	0.250 0.075	6.4 1.9	Hemisphere	Clear

Quiet Clear Series

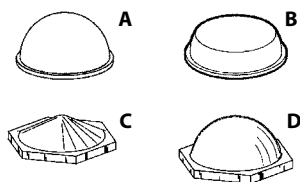

Dimensions:

Part #		English +/- 0.02 In.	Metric +/- 0.5 Mm	Style	Color
A SJ-6506	DIAMETER: HEIGHT:	0.375 0.150	9.5 3.8	Hemispherical	Clear
B SJ-6512	DIAMETER: HEIGHT:	0.500 0.140	12.7 3.5	Cylindrical	Clear
C SJ-6553	WIDTH: HEIGHT:	0.433 0.120	11.0 3.05	Hexagonal Cone	Clear
D SJ-6561	LENGTH: HEIGHT:	0.433 0.150	11.0 3.8	Hexagonal Hemisphere	Clear

Bright White (Pure White)



Dimensions:

Part #		English +/- 0.02 In.	Metric +/- 0.5 Mm	Style	Color
SJ-5412	WIDTH: HEIGHT:	0.507 0.14	12.7 3.6	Cylindrical	Bright White

Heavy Duty



Dimensions:

Part #		English +/- 0.02 In.	Metric +/- 0.5 Mm	Style	Color
SJ-5532BR	WIDTH:	1.88	47.7	Circular Depressed	Brown
SJ-5532BK	HEIGHT:	0.66	16.7		Black

Colors

EXCELLENT FOR GLASS TABLES, CABINET DOOR, LIDS & DRAWERS!



Dimensions:

Part #			Dimensions:		Style	Color
			English +/- 0.02 In.	Metric +/- 0.5 Mm		
A	SJ-5001BK	WIDTH: 0.50 HEIGHT: 0.14	0.50 0.14	12.7 3.5	Cylindrical	Black
B	SJ-5003WH	WIDTH: 0.44 HEIGHT: 0.20	0.44 0.20	11.1 5.0	Hemisphere	White
	SJ-5003GY					Grey
	SJ-5003BK					Black
C	SJ-5007BK	WIDTH: 0.40 HEIGHT: 0.12	0.40 0.12	10.2 2.5	Tapered Square	Black
D	SJ-5008WH	WIDTH: 0.50 HEIGHT: 0.12	0.50 0.12	12.7 3.1	Tapered Square	White
	SJ-5008GY					Grey
	SJ-5008BK					Black
E	SJ-5009WH	WIDTH: 0.88 HEIGHT: 0.40	0.88 0.40	22.3 10.1	Circular Depressed	White
	SJ-5009BK					Black
F	SJ-5012WH	WIDTH: 0.50 HEIGHT: 0.14	0.50 0.14	12.7 3.5	Cylindrical	White
	SJ-5012BR					Brown
	SJ-5012BK					Black
G	SJ-5017WH	WIDTH: 0.75 HEIGHT: 0.38	0.75 0.38	19.0 9.6	Hemisphere	White
	SJ-5017BK					Black
H	SJ-5018WH	WIDTH: 0.50 HEIGHT: 0.23	0.50 0.23	12.7 5.8	Tapered Square	White
	SJ-5018GY					Grey
	SJ-5018BR					Brown
I	SJ-5023WH	WIDTH: 0.81 HEIGHT: 0.30	0.81 0.30	20.5 7.6	Tapered Square	White
	SJ-5023GY					Grey
	SJ-5023BK					Black
J	SJ-5027WH	WIDTH: 0.63 HEIGHT: 0.31	0.63 0.31	16.0 7.9	Hemisphere	White
	SJ-5027GY					Grey
K	SJ-5076BK	WIDTH: .315 HEIGHT: 0.11	.315 0.11	8.0 2.8	Cylindrical	Black
L	SJ-5508BK	WIDTH: 0.50 HEIGHT: 0.12	0.50 0.12	12.7 3.1	Tapered Square	Black
M	SJ-5514WH	WIDTH: 0.81 HEIGHT: 0.52	0.81 0.52	20.6 13.1	Tapered Square	White
	SJ-5514GY					Grey
	SJ-5514BK					Black
N	SJ-5705BK	WIDTH: 1.25 HEIGHT: 0.24	1.25 0.24	31.75 6.1	Tapered Square	Black
O	SJ-5744BK	WIDTH: 0.75 HEIGHT: 0.16	0.75 0.16	19.1 4.1	Cylindrical	Black

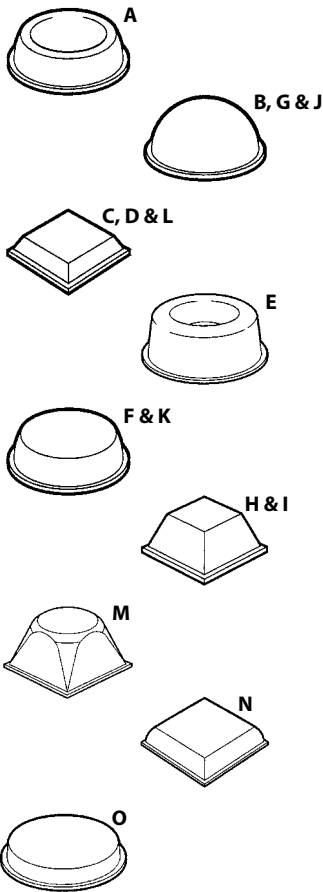

^ THE ITEMS LISTED AS WHITE ARE AN OFF WHITE COLOR. THE BRIGHT IS PURE WHITE IN COLOR.

Top Hat

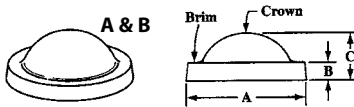

Part #	Dimensions:			Style	Color
	A	B	C		
A SJ-6115	.625	.093	.187	Flat Top Hat	Black
B SJ-6125	.625	.093	.187	Round Top Hat	Black

Budget Friendly Clear Bumpers

Material: Polyurethane

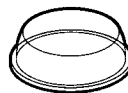

Part #	Width	Height
BFF-20	.500"	.14"

Polyurethane Adhesive Bumpers



PAB-001



PAB-002



PAB-003



PAB-006, PAB-106



PAB-008



PAB-009



PAB-010



PAB-012, PAB-112



PAB-016

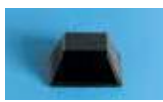

PAB-018, PAB-023



PAB-026



PAB-029



PAB-031



PAB-032



PAB-044



PAB-050



PAB-078



PAB-057



PAB-083

Part #	Width	Height
PAB-001CL	.500"	.140"
PAB-002CL	.312"	.085"
PAB-003CL	.440"	.200"
PAB-006CL	.375"	.150"
PAB-008CL	.500"	.120"
PAB-009CL	.880"	.400"
PAB-010CL	.780"	.380"
PAB-012CL	.500"	.140"
PAB-016CL	.810"	.120"
PAB-018CL	.500"	.230"
PAB-023CL	.810"	.300"
PAB-026CL	.720"	.560"
PAB-029CL	.335"	.085"
PAB-031CL	.750"	.750"
PAB-032CL	1.810"	.600"
PAB-044CL	.750"	.160"
PAB-050CL	.787"	.886"
PAB-057CL	.500"	.060"
PAB-078CL	.400"	.118"
SOFT SERIES - Softer bumper for extra sound deadening properties		
PAB-083CL	.500"	.200"
PAB-106CL	.375"	.150"
PAB-112CL	.500"	.140"

All bumpers stocked in clear
Please inquire for colors. Colors sold in full cases only.

Non-Skid Pads

EMBOSED BLACK

Our Non-Skid Pads consist of specially formulated thermoplastic rubber material fused to cross-linked polyethylene foam with adhesive backing.

**Kitchen Appliances
Office & Desk Accessories
Computer Terminal Equipment
Medical Devices**

- High durability
- Non-marring
- Abrasive resistance
- Chemical & water resistant

DIE-CUTTING AVAILABLE, PLEASE INQUIRE.

50 Ft. Rolls	Part #	Description
	NS-1600-4	1/2" Wide x 1/8" Thick
	NS-1600-2	1/2" Wide x 1/16" Thick
	NS-3200-4	1" Wide x 1/8" Thick
	NS-3200-2	1" Wide x 1/16" Thick

Shape	Part #	Description
	NS-0016-4	1/2" Dia. x 1/8" Thick
	NS-0016-2	1/2" Dia. x 1/16" Thick
	NS-3232-4	1" x 1" x 1/8" Thick
	NS-3232-2	1" x 1" x 1/16" Thick
	NS-3264-4	1" x 2" x 1/8" Thick
	NS-3264-2	1" x 2" x 1/16" Thick
	NS-3296-4	1" x 3" x 1/8" Thick
	NS-3296-2	1" x 3" x 1/16" Thick

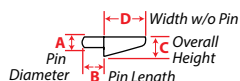

To calculate shelf length, use the following formula: inside cabinet width - shelf clearance = shelf size

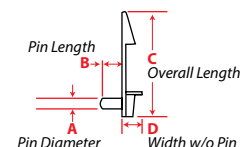

Steel & Flat Shelf Rests

SPOON SHelf RESTS

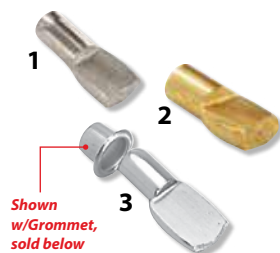

	Part #	Finish	Material	A	B	C	D	Shelf Clearance
1	R25-228-NI	Bright Nickel	Steel	5mm	5/16"	3/4"	7/16"	1/8"
	R25-228-BRS	Bright Brass	Steel	5mm	5/16"	3/4"	7/16"	1/8"
	R25-228-BZ	Bronze	Steel	5mm	5/16"	3/4"	7/16"	1/8"
2	R25-128-NI	Bright Nickel	Steel	1/4"	3/8"	7/8"	1/2"	1/8"
	R25-128-BRS	Bright Brass	Steel	1/4"	3/8"	7/8"	1/2"	1/8"
3	R25-450NP-SS	Bright Nickel	Steel	7mm	3/8"	15/16"	9/16"	1/8"
	R25-450BRS-SS	Bright Brass	Steel	7mm	3/8"	15/16"	9/16"	1/8"

STEEL SHelf RESTS w/SOFT BROWN PVC SLEEVE



	Part #	Finish	Material	A	B	C	D	Shelf Clearance
	R25-300NI	Bright Nickel	Steel w/Brown PVC Sleeve	1/4"	7/16"	1-1/4"	3/4"	1/8"
	R25-300BR	Bright Brass	Steel w/Brown PVC Sleeve	1/4"	7/16"	1-1/4"	3/4"	1/8"
	R25-305NI	Bright Nickel	Steel w/Brown PVC Sleeve	5mm	7/16"	1-1/4"	3/4"	1/8"
	R25-305BR	Bright Brass	Steel w/Brown PVC Sleeve	5mm	7/16"	1-1/4"	3/4"	1/8"

ZINC DIECAST SPOON SHelf RESTS



	Part #	Finish	Material	A	B	C	D	Shelf Clearance
	SH-700Z	Bright Nickel	Zinc Diecast	1/4"	7/16"	1"	5/8"	1/8"
	SH-700B	Bright Brass	Zinc Diecast	1/4"	7/16"	1"	5/8"	1/8"

STRAIGHT DOWEL SHelf RESTS



	Part #	Finish	Material	A	B	C	D	Shelf Clearance
	PSR-02CH	Chrome	Steel	5mm	5/16"	11/16"	N/A	1/8"
	PSR-02BR	Bright Brass	Steel	5mm	5/16"	11/16"	N/A	1/8"

HOLE GROMMETS

- Designed to be used in shelf rest holes as a decorative accent
- This accepts a specific size shelf rest, therefore the drill hole will need to be slightly larger

NO BROKEN BOXES - 1000 pcs. minimum order



	Part #	Finish	Material	Pin Diameter	Overall Size
	R25-450NP-GT	Bright Nickel	Steel	7mm	1/2" Dia. x 1/4" High
	R25-128BRS-GT	Bright Brass	Steel	1/4"	25/64" Dia. x 5/16" High
	R25-128NI-GT	Bright Nickel	Steel	1/4"	25/64" Dia. x 5/16" High

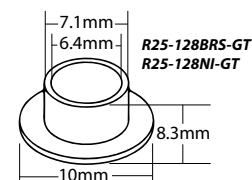

STEEL PIN SHelf REST w/PLASTIC HOUSING (Smooth)



	Part #	Color	Material	A	B	C	D	Shelf Clearance
	R25-728CL	Clear	Brite Nickel Pin w/Polycarbonate Housing	5mm	1/4"	1-1/4"	3/8"	3/16"
	R25-500CL	Clear	Brite Nickel Pin w/H.D.P.E. Housing	5mm	1/4"	11/16"	5/16"	3/16"
	R25-500BR	Brown	Brite Nickel Pin w/H.D.P.E. Housing	5mm	5/16"	5/8"	3/8"	1/8"
	R25-500WH	White	Brite Nickel Pin w/H.D.P.E. Housing	5mm	5/16"	5/8"	3/8"	1/8"

GLASS SHelf RESTS



	Part #	Finish	Material	A	B	C	D	Shelf Clearance
	SH-138	Brite Nickel	Nickel Plated w/PVC Nonskid Pad	5mm	5/16"	1"	11/16"	1/8"



Adjustable,
Holds 3/16" to
1/4" Glass

	Part #	Finish	Material	A	B	C	D
	SH-450	Brite Nickel	Nickel Plated w/PVC Nonskid Pad	3/16"	7/16"	1-1/16"	11/16"

IF YOU ARE LOOKING TO COVER SHelf REST HOLES, SEE PAGE G-5 FOR OUR FASTCAP™ SELECTIONS

Shelf Rests

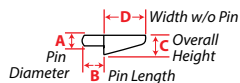

To calculate shelf length, use the following formula: inside cabinet width - shelf clearance = shelf size

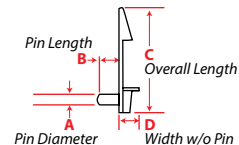

Locking Shelf Rests

PLASTIC LOCKING SHELF RESTS (Fluted Pin)

Designed to hold shelves securely in place



	Part #	Color	Material	A	B	C	D	Shelf Thickness	Shelf Clearance
1	JPE-301-34-010-1	White	ABS	1/4"	5/16"	2-1/4"	1/2"	3/4"	1/4"
	R25-604-500-CL	Clear	Polycarbonate	1/4"	5/16"	1-3/4"	1/2"	1/2"	7/32"
2	R25-604-625-CL	Clear	Polycarbonate	1/4"	5/16"	1-7/8"	1/2"	5/8"	7/32"
	R25-604-750-CL	Clear	Polycarbonate	1/4"	5/16"	2"	1/2"	3/4"	7/32"
	R25-805-500-CL	Clear	Polycarbonate	5mm	1/4"	1-3/4"	1/2"	1/2"	7/32"
3	R25-805-625-CL	Clear	Polycarbonate	5mm	1/4"	1-7/8"	1/2"	5/8"	7/32"
	R25-805-750-CL	Clear	Polycarbonate	5mm	1/4"	2"	1/2"	3/4"	7/32"
	OPHS-1826-BK	Black	Nylon 6	5mm	15/64"	1-11/16"	1/4"	1/2"	3/16"
4	OPHS-1826-BR	Brown	Nylon 6	5mm	15/64"	1-11/16"	1/4"	1/2"	3/16"
	OPHS-1829-CL	Clear	Polycarbonate	5mm	15/64"	1-11/16"	1/4"	3/4"	3/16"
	R25-244-625WH	White	H.D.P.E.	5mm	3/8"	1-5/8"	1/2"	5/8"	7/32"
5	R25-244-750WH	White	H.D.P.E.	5mm	3/8"	1-7/8"	1/2"	3/4"	7/32"
	R25-244-750BE	Beige	H.D.P.E.	5mm	3/8"	1-7/8"	1/2"	3/4"	7/32"

Institutional & Locking Shelf Rests



INSTITUTIONAL LOCKING SHELF REST (Smooth Pin)

- Over 300 pound shear test
- Supports shelf loads over 500 lbs
- Ideal for commercial or institutional furniture
- For extra support, this can be screwed to the side panel of the cabinet
- Can withstand earthquakes

Part #	Color	Material	A	B	C	D	Shelf Thickness	Shelf Clearance
R25-BGD-CL	Clear	Polycarbonate	Twin 5mm	5/16"	2-1/2"	1/2"	3/4" or 1"	1/4"



LOCKING MEDICINE CABINET SHELF REST (Smooth)

Accepts up to 1/8" shelf and designed so that the shelf will not shimmy

Part #	Color	Material	A	B	C	D	Shelf Thickness	Shelf Clearance
R25-CK	Clear	Polycarbonate	5MM	5/16"	1/2"	1/2"	1/8"	3/16"



PLASTIC SHELF LOCKING SYSTEM - 2 PIECE 32mm

Holds shelf in place

Part #	Color	Material	A
SH-103113	White	Nylon	5MM



GLASS SHELF RESTS

Part #	Color	Material	A	B	C	D	Shelf Thickness	Shelf Clearance
R25-605CL	Clear	H.D.P.E.	1/4"	3/8"	7/8"	1/2"	3/16"	1/8"
R25-806CL	Clear	H.D.P.E.	5mm	3/8"	7/8"	1/2"	1/4"	1/8"

IF YOU ARE LOOKING TO COVER SHELF REST HOLES, SEE PAGE G-5 FOR OUR FASTCAP™ SELECTIONS

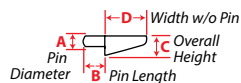

To calculate shelf length, use the following formula: inside cabinet width - shelf clearance = shelf size

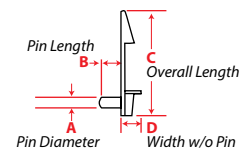

Spoon & Locking Shelf Rests

STANDARD DUTY SHELF RESTS (Fluted Pin)

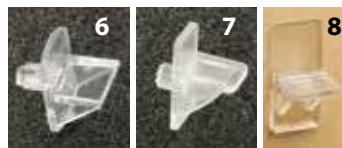

	Part #	Color	Material	A	B	C	D	Shelf Clearance
6	R25-470CL	Clear	Lexan	1/4"	11/32"	3/8"	3/8"	7/32"
7	R25-350CL	Clear	Lexan	1/4"	5/16"	1"	1/2"	7/32"
8	R25-241CL	Clear	Polycarbonate	5mm	1/4"	1"	1/2"	7/32"

EXTRA LONG SHELF REST (Fluted)



	Part #	Color	Material	A	B	C	D	Shelf Clearance
	R25-471CL	Clear	Polycarbonate	1/4"	3/8"	1/2"	1"	5/64"

IF YOU ARE LOOKING TO COVER SHELF REST HOLES, SEE PAGE G-5 FOR OUR FASTCAP™ SELECTIONS

Cabinet Hardware

Steel Pilaster



- Bright Zinc Finish
- Surface or recess mount
- Pre-Drilled screw holes & stamped numbers for easy installation
- 5/8" W x 1/8" D
- 1/2" Hole Spacing

Part #	Length
HB101PZ-18	18"
HB101PZ-24	24"
HB101PZ-30	30"
HB101PZ-36	36"
HB101PZ-48	48"
HB101PZ-60	60"
HB101PZ-72	72"
HB101PZ-84	84"
HB101PZ-96	96"

*Mounts with #6 or #8 screws, sold separately. See page G-32

Part #	Description
HB107CZ	Pilaster Clips

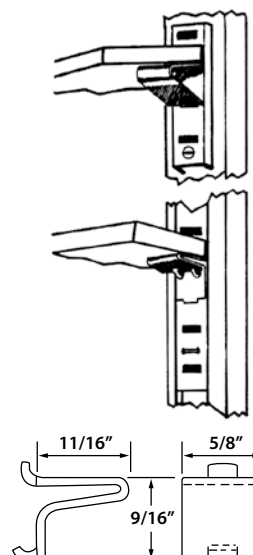

Flat & Pan Head Particle Board Screws

Flat Head Screws

Zinc or Black • Phillips Drive • Coarse Thread

Part #	Finish	Size	Bulk Ctn Qty.
SCR-5500FHZ	Zinc	#5 x 1/2"	25,000
SCR-5625FHZ	Zinc	#5 x 5/8"	20,000
SCR-6500FHZ	Zinc	#6 x 1/2"	20,000
SCR-6625FHZ	Zinc	#6 x 5/8"	15,000
SCR-6100FHZ	Zinc	#6 x 1"	10,000
SCR-6150FHZ	Zinc	#6 x 1-1/2"	10,000
SCR-8625FHZ	Zinc	#8 x 5/8"	12,000
SCR-8750FHZ	Zinc	#8 x 3/4"	10,000
SCR-8100FHZ	Zinc	#8 x 1"	10,000
SCR-8150FHZ	Zinc	#8 x 1-1/2"	10,000
SCR-1625FHZ	Zinc	#10 x 5/8"	10,000
SCR-1750FHZ	Zinc	#10 x 3/4"	8,000
SCR-5500FHB	Black	#5 x 1/2"	25,000
SCR-5625FHB	Black	#5 x 5/8"	20,000
SCR-6500FHB	Black	#6 x 1/2"	20,000
SCR-6625FHB	Black	#6 x 5/8"	15,000
SCR-8625FHB	Black	#8 x 5/8"	12,000
SCR-8750FHB	Black	#8 x 3/4"	10,000
SCR-1625FHB	Black	#10 x 5/8"	10,000
SCR-1750FHB	Black	#10 x 3/4"	8,000

Pan Head Screws

Zinc or Black • Phillips Drive • Coarse Thread

Part #	Finish	Size	Bulk Ctn Qty.
SCR-6500PHZ	Zinc	#6 x 1/2"	20,000
SCR-6625PHZ	Zinc	#6 x 5/8"	15,000
SCR-6100PHZ	Zinc	#6 x 1"	10,000
SCR-8500PHZ	Zinc	#8 x 1/2"	15,000
SCR-8625PHZ	Zinc	#8 x 5/8"	12,000
SCR-8750PHZ	Zinc	#8 x 3/4"	10,000
SCR-8100PHZ	Zinc	#8 x 1"	8,000
SCR-1625PHZ	Zinc	#10 x 5/8"	10,000
SCR-1750PHZ	Zinc	#10 x 3/4"	8,000
SCR-1875PHZ	Zinc	#10 x 7/8"	7,000
SCR-1100PHZ	Zinc	#10 x 1"	6,000
SCR-6500PHB	Black	#6 x 1/2"	20,000
SCR-6625PHB	Black	#6 x 5/8"	15,000
SCR-6100PHB	Black	#6 x 1"	10,000
SCR-8500PHB	Black	#8 x 1/2"	15,000
SCR-8625PHB	Black	#8 x 5/8"	12,000
SCR-8750PHB	Black	#8 x 3/4"	10,000
SCR-8100PHB	Black	#8 x 1"	8,000
SCR-1625PHB	Black	#10 x 5/8"	10,000
SCR-1750PHB	Black	#10 x 3/4"	8,000
SCR-1875PHB	Black	#10 x 7/8"	7,000
SCR-1100PHB	Black	#10 x 1"	6,000

Machine Screws/Breakaway Screws

Zinc • Phillips Slotted • Round Head

Part #	Finish	Size	Bulk Ctn Qty.
SCR-8321THZ	Zinc	8 x 32 x 1"	10,000
SCR-8321THZ-BA	Zinc	8 x 32 x 1-3/4"	10,000



Finishing Washers

COLOR: NATURAL NYLON

REACH & ROHS
COMPLIANT

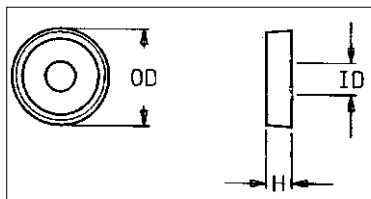

Part #	Screw Size	ID		OD		H	
		In.	Mm	In.	Mm	In.	Mm
CFW-6	6	.143	3.63	.437	11.10	.100	2.54
CFW-8	8	.171	4.34	.515	13.08	.115	2.92

Furniture Assembly Fasteners

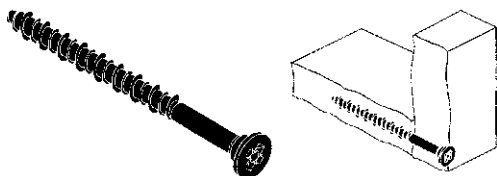

POSI SCREWS

250 PIECES PER CARTON

Titus

Part #	Description
OP-0071	8x33mm HI-LO Funnel Head
OP-0077	8x45mm HI-LO Funnel Head
OP-6077	8x50mm HI-LO Funnel Head



Fast, easy, secure anchoring in ALL building materials — drywall, gypsum board, brick, concrete, block, stone, plaster ...

- No special tools needed
- Stronger than any anchor of comparable screw size

TOGGLER® BRAND SnapSku® Self Drilling Drywall Anchor

Securely hang alarms, mirrors, bathroom accessories, picture frames, drapery, lighting fixtures, smoke detectors, thermostats, electric boxes, etc.

- Material: Glass Filled Nylon
- Positive "stop" prevents overturning
- Can be used with a screw gun or hand drill
- Activates & locks with an audible "pop" indicating correct installation

Part #	Description	Grip	Screw ^	Screws	Box
TA-0012	SP™ drywall anchors	3/8"-5/8"	#6-#10	50	50

^ # 8 Screw Preferred

#8 x 1 1/2" COMBO HEAD SCREWS INCLUDED IN TA-0012 BOXES. EACH ITEM IS SOLD IN FULL BOXES ONLY - NO BROKEN BOXES

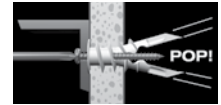
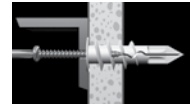

TOGGLER® BRAND SNAPTGGLE® Toggle Bolt

Superior holding for heavy-duty anchoring in hollow walls and ceilings. Use in drywall, concrete block, plaster, tile over drywall, or tile over greenboard.

- Material: Zinc plated carbon steel & high impact polystyrene
- Carry twice the load in a smaller hole than standard wing toggles
- No spinning when used with a screw gun

Part #	Description	Thread	Drill	Grip	Box
TA-1013	BA™ snaptoggle toggle bolt	3/16"-24	1/2"	3/8"-3-5/8"	100
TA-1014	BB™ snaptoggle toggle bolt	1/4"-20	1/2"	3/8"-3-5/8"	100
TA-1015	BC™ snaptoggle toggle bolt	3/8"-16	3/4"	3/8"-2-1/2"	25
TA-1016	BD™ snaptoggle toggle bolt	1/2"-13	3/4"	3/8"-2-1/2"	25

THREADED BOLTS ARE NOT INCLUDED - EACH ITEM IS SOLD IN FULL BOXES ONLY - NO BROKEN BOXES

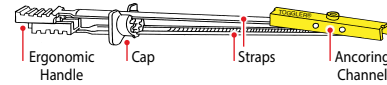

BA 3/16"-24 • BB 1/4"-20 =
Drill diameter: 1/2" (13mm)

BC 3/8"-16 • BD 1/2"-13 =
Drill diameter: 3/4" (19mm)

Minimum clearance behind wall:
1 7/8" (48mm)



TOGGLER® BRAND ALLIGATOR® Solid Wall Concrete Anchors

- Material: Self-lubricating polypropylene
- Corrosion proof when used with stainless steel screws
- Can be used with a screw gun
- Fins prevent spinning and countersink in the hole



Part #	Description	Screw	Drill	Box
TA-3103	AF™ 3/16" dia. flanged anchors	#4-#10	3/16"	200
TA-3101	AF6™ 1/4" dia. flanged anchors	#6-#14	1/4"	100
TA-3102	AF8™ 5/16" dia. flanged anchors	#6-5/16	5/16"	100
TA-3106	AF5™ 3/16" dia. flush mount anchors	#4-#10	3/16"	200
TA-3104	AF6™ 1/4" dia. flush mount anchors	#6-#14	1/4"	100
TA-3105	AF8™ 5/16" dia. flush mount anchors	#6-5/16	5/16"	100

EACH ITEM IS SOLD IN FULL BOXES ONLY - NO BROKEN BOXES

TOGGLER® Specialty Anchors

- Material: Non-Corrodable polypropylene
- Vibration & shock proof
- Specially designed heads for specialized applications

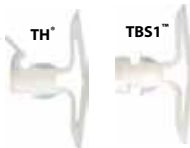

Part #	Description	Grip	Screw	Drill	Box
TA-1012	TH® picture hook anchors	3/8"-1/2"	#6-#14	5/16"	100
TA-1023	TBS1™ shelving anchors	3/8"-1/2"	#7 x 1-3/4"	5/16"	50
TA-1022	TBS2™ pegboard anchors	3/8"-1/2"	#7 x 1-3/4"	5/16"	50
TA-1024	TBW™ wire shelf anchors	3/8"-1/2"	#7 x 1-3/4"	5/16"	50

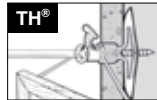

Use for hanging pictures and mirrors on hollow or solid walls. Also used to string TV cable or phone wire.

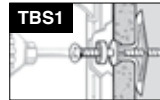

One-piece anchor with spacer for installing C-channel wall standards in perfect alignment and preventing jackout of the anchor.

Economy Hollow Wall Anchor

- Material: Polypropylene
- Color: White

HW-ANCHOR
Grip: 3/8"-7/16"
Screw: #9-#13
Drill: 5/16"
Box: 100



TOGGLER® Hollow-Wall Anchors

- Material: Non-Corrodable polypropylene
- Positive locking system provides increased holding strength
- Vibration & shock proof
- Anti-rotation fins prevent spinning in the hole

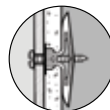

TA®
Hollow doors & thin panels

Part #	Description	Grip	Screw	Drill	Box
TA-1009	TA® hollow door anchors	1/8"-1/4"	#8-#12	5/16"	100
TA-1010	TB® drywall anchors	3/8"-1/2"	#6-#14	5/16"	100
TA-1011	TC® drywall anchors	5/8"-3/4"	#6-#14	5/16"	100
TA-1021	TD® drywall anchors	1"	#6-#14	5/16"	50
TA-1029	T35® drywall anchors	1-3/8"	#6-#14	5/16"	50

TB®
Residential drywall applications

EACH ITEM COMES WITH 3 SETTING KEYS PER BOX - EACH ITEM IS SOLD IN FULL BOXES ONLY - NO BROKEN BOXES

Economy Flush Mount Drywall Anchor

- Material: Polypropylene
- Used for through the fixture mounting
- 1/4" Diameter



Part #	Overall Length	Screw	Drill
STD-ANCHOR	1-5/8"	#8	1/4"
STD-ANCHOR-6	1-3/16"	#6	1/4"

SOLD IN BOXES OF 100 - NO BROKEN BOXES

Modesty Block

Material: Polyethylene

- Designed to attach modesty panels to desks
- No pre-drilling required, three screw application
- Place block against inside modesty panel & tighten screws; place panel against desk front & tighten third screw from block bottom into desk top.

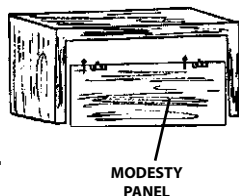
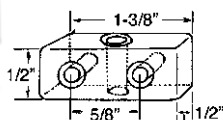

Part #
6073-BR Brown

Use #8 flathead screws (see below)

KD Brackets

Material: Steel, Zinc Finish

- Countersunk holes
- 14 GA Steel

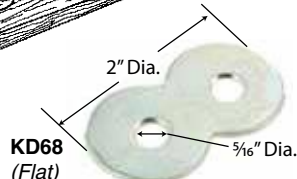
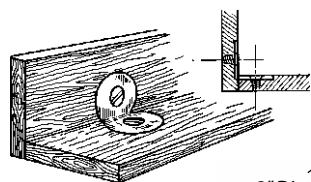
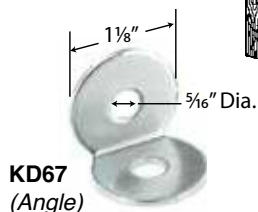

Part #
KD67-ZINC
KD68-ZINC

Use #10 flathead screws (see below)

Fasteners

HF-1 HOOK-IN FITTINGS

Material: Polycarbonate

- Hook-in fittings for mounting of panels, for built-in cabinets, room dividers, etc.

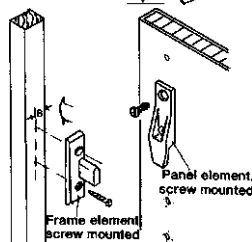
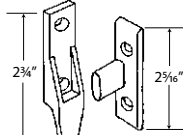

Part #
HF-1 Black

LF-1 LIFT-OFF FITTINGS

Material: Polycarbonate

- Lift-off fittings for connecting panels

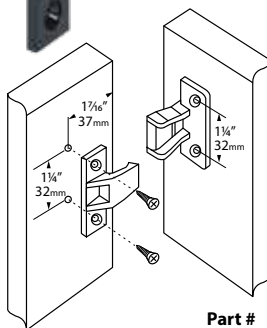

Part #
LF-1 Black

Use #8 flathead screws (see right)

Furniture Joiner Hardware

Material: Steel, Zinc Finish



CORNER BRACE

Part #	Description
CB-10	1" x 1" x 5/8" x 16 GA.
CB-15	1-1/2" x 1-1/2" x 5/8" x 14 GA.
CB-20	2" x 2" x 5/8" x 14 GA.
CB-40	4" x 4" x 7/8" x 13 GA.

Use #8 flathead screws (see below)

Angle Brackets

Material: H.D.P.E.

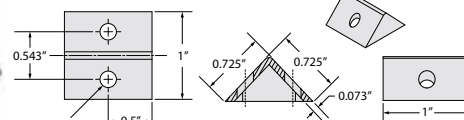

Part #
R44-200BK Black
R44-200WH White

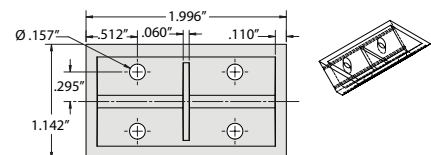

Part #
R44-210BK Black
R44-210WH White

Use #6 panhead screws (see below)

Screws

FLAT HEAD ZINC SCREWS

Part #	Size
SCR-6625FHZ	#6 x 5/8"
SCR-8625FHZ	#8 x 5/8"
SCR-1625FHZ	#10 x 5/8"

PAN HEAD ZINC SCREWS

Part #	Size
SCR-6625PHZ	#6 x 5/8"

Fully Concealed Hidden Joining System

- Material: Glass Reinforced Nylon
- UV and Fire Rated
- Guaranteed to save on production time and labor costs because it's easy to install and you do not need to wait for glue to dry.
- Units can ship knock down. Less money will be spent on transportation.
- Reduce inventory levels on other fastening components when you switch to this system. Very cost effective and requires less fasteners.
- There is no need to buy expensive new tooling because this system allows you to use standard router, screw drivers or CNC machine.



Striplox Pro 23



This connector has over 100 uses and can be used in a variety of applications ranging from large scale Architectural projects to hanging artwork or building floating shelves

Striplox Pro 55



Striplox Clip 50



Designed for small and precise applications, while providing a secure connection in the tightest of places.

Striplox Mini 60



Allows the user to create fully concealed joints.

Striplox Mini 120



Striplox 90D 98



Designed to quickly and easily connect any right angle, miter box and flush joints.

Striplox 180D



Allows you to easily join tables together at conference venues and restaurants in less than a minute.

Striplox Griplox



Is a great alternative to traditional wood biscuits. No more glue, no more waiting time and no more bulge.

Striplox Megalox



Megalox is ideal for bench, table top installations with mitre joints, T joints or box joints.

For Striplox Starter Kits, See Page G-39

Striplox Pro 23 & 55

- **Type of Application:** Ceiling panels, acoustic panels, timber battens, floating shelves, furniture, bookcases, mirrors, RV and marine, exhibition/tradeshows events, shop fitting displays and signage.
- **Connection:** Male and female, ideally male is mounted to the wall, ceiling or other surfaces.
- Designed for panels, frames or components. This hidden mounting system delivers a flawless finish with a perfect alignment every time.
- Very strong and durable and will support the load capacity evenly over the entire product.
- Cabinetry or panels can be fitted permanently or removed and re-used with ease.
- 2 sizes to choose from with slim design for easy concealment.
- **Mounting Options:** Horizontal, Vertical and Ceiling Mount
- **Board or Panel Materials To Use:** Solid Wood, MDF, Composite Materials, Aluminum, Acrylic and More
- **Lock Tab:** Lock tab for permanent mounting or remove when repeated access is needed.

Part #	Description	Color
SPX-P23	Striplox Pro 23	Black
SPX-P55	Striplox Pro 55	Black

See Mounting Accessories On Page G-36

Striplox Pro 23

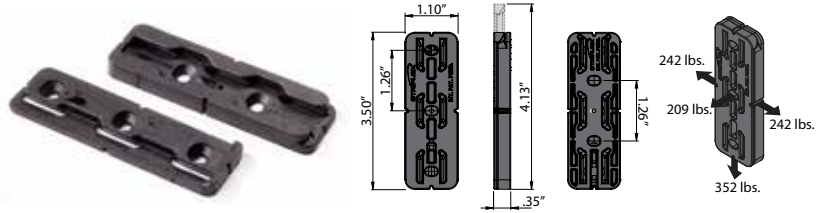

- **Lift Clearance (Direction of Travel):** 1/2" (12.7mm)
- **Projection- Surface Mounted:** .38" (9.5mm)
- **Projection- Recessed Mounted:** Sits flush against the wall
- **Projection- Set Back Mounted:** .08" to .30"
- **Size of Screws:** #8 x 5/8"
- **# of Screws:** 5 pieces
- **Screw Adjustment:** Yes
- 32MM Compatible

Striplox Pro 55

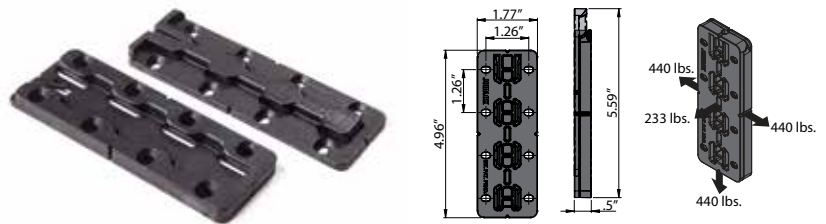

- **Lift Clearance (Direction of Travel):** 3/4" (19mm)
- **Projection- Surface Mounted:** .50" (12.8mm)
- **Projection- Recessed Mounted:** Sits flush against the wall
- **Projection- Set Back Mounted:** .15" or .35"
- **Size of Screws:** #8 x 5/8"
- **# of Screws:** 16 pieces
- **Screw Adjustment:** Yes
- 32MM Compatible

Striplox Clip 50

- **Type of Application:** Wall, cabinetry, commercial panels, acoustic panels, signage, exhibition & shop fitting.
- **Connection:** Male and female, ideally male is mounted to the wall, ceiling or other surfaces.
- Its unique design allows you to mount your products to uneven walls.
- Can be screw or glue mounted.
- Stronger than many panel mounting options on the market today.
- **Mounting Options:** Horizontal, Vertical and Ceiling Mount
- **Board or Panel Materials To Use:** Solid Wood, MDF, Composite Materials, Aluminum, Acrylic and More
- **Lock Tab:** Lock tab for permanent mounting or remove when repeated access is needed.

- **Lift Clearance (Direction of Travel):** 1/4" (6.4mm)
- **Projection- Surface Mounted:** .38" (9.5mm)
- **Projection- Recessed Mounted:** Sits flush against the wall
- **Projection- Set Back Mounted:** .125" to .25"
- **Size of Screws:** #8 x 5/8"
- **# of Screws:** 4 pieces
- 32MM Compatible

Part #	Color
SPX-C50	Black

See Mounting Accessories On Page G-38

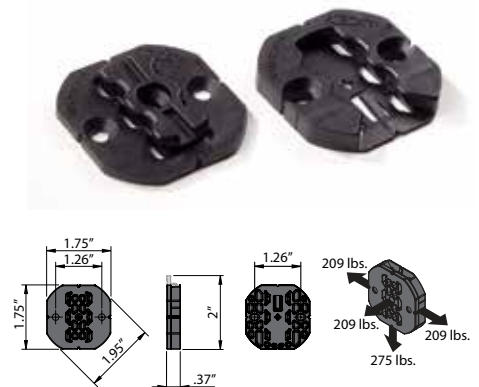

Striplox Mini 60 & 120

- **Type of Application:** Commercial, domestic and architectural furniture, wardrobe closets, cabinetry, framing of artwork and mirrors, RV and marine fit outs and locker room.
- **Connection:** Male and female mortised into position.
- Replaces the need to use biscuit joints, fasteners or cam dowels. This saves time on labor with a quick and easy install. Completely hidden joint.
- The connectors produce a tight and strong joint either in permanent or reversible applications.
- Will not interfere with substrate finishes, such as veneers and paint.
- **Mounting Options:** Horizontal, Vertical and Lock Up Mount
- **Board or Panel Materials To Use:** Solid Wood, MDF and Other Composite Materials

Part #	Description	Color
SPX-M60	Striplox Mini 60	Black
SPX-M120	Striplox Mini 120	Black

See Mounting Accessories On Page G-38



- **Lock Tab:** Lock position is a click, no tab to remove.
- **Board Depth:** .394"

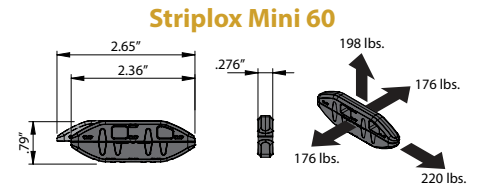

- **Lift Clearance (Direction of Travel):** 5/16" (8mm)
- **Projection- Recessed Mounted:** Fully Concealed Joints



- **Lock Tab:** Lock tab for permanent mounting or must be sanded off or sliced off with a utility knife.
- **Board Depth:** .394"
- **Lift Clearance (Direction of Travel):** 7/16" (11mm)
- **Projection- Recessed Mounted:** Fully Concealed Joints

Striplox Mini 120

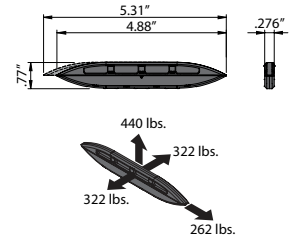

Striplox 90D 98

- **Type of Application:** Bulk head and kickboard, furniture, shop fitting displays and signage, exhibition and tradeshow events.
- **Connection:** Male and female, ideal male is mounted to the wall ceiling or other surface. Surface mounted ideal for any right angle.
- This patented design pulls the substrate firmly together to form a strong and tight joint in one simple action by distributing the loads evenly over the entire connector and joint.
- The joint is not visible once the cover is snapped into place.
- Can create a perfect 90 degree angle.
- **Mounting Options:** Horizontal, Vertical and Side Mount
- **Board or Panel Materials To Use:** Solid Wood, MDF and Other Composite Materials
- **Lock Tab:** Cannot be removed, but can be overridden when you start the connection from the beginning of the clip.

	Part #	Color
A	SPX-90DBK	Black
	SPX-90DWH	White
B	SPX-90DBK-51	Black

See Mounting Accessories On Page G-38

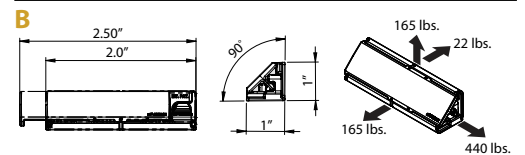
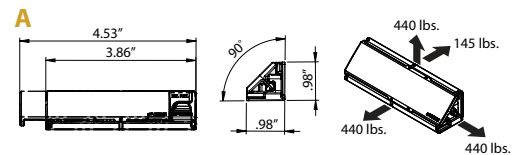

Striplox Griplox

- **Type of Application:** Anywhere traditional wood biscuits are used.
- **Connection:** Knock in (no glue required) std NO.20 biscuit slot.
- Easy to install, use standard biscuit cutter and simply knock in with a hammer.
- Unique gripping spikes on the front and back secure your project in place without glue.
- **Mounting Options:** Horizontal & Vertical
- **Board or Panel Materials To Use:** Solid Wood, MDF and Other Composite Materials

Part #	Color
SPX-GP20	Black

See Mounting Accessories On Page G-38

- **Board Depth:** .394"
- **Projection- Recessed Mounted:** Fully concealed joints

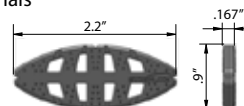

Striplox 180D

- **Type of Application:** Conference room tables, kitchen and benchtop tables, workstations, retail displays, signage and large exhibition displays.
- **Connection:** Male and female, ideally male is mounted to the wall, ceiling or other surfaces.
- Primarily used when you need to join items at 180 degrees.
- Can be used even when board is already laminated.
- Very secure connection. The round disc locks closed by hand. Some force is required to unlock.
- **Mounting Options:** Horizontal, Vertical and Under Mount
- **Board or Panel Materials To Use:** Solid Wood, MDF and Other Composite Materials
- **Lock Tab:** Must add a screw in designated hole to make permanent.

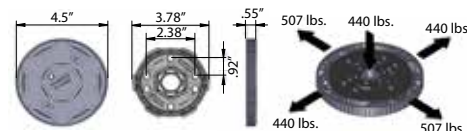

Part #	Color
SPX-180D	Black

See Mounting Accessories Below

- Board Depth: 3/4"
- Projection- Surface Mounted: 1/2"
- Size of Screws: #8 x 5/8"
- # of Screws: 6 pieces
- 32MM Compatible

Striplox Megalox

- **Type of Application:** Bathroom, office, toilet or locker room partitions and bench top waterfalls.
- **Connection:** Male and female mortised into position.
- When creating a waterfall, saves time and because there is no glue to dry.
- Will allow you to create a perfect alignment.
- Can support heavy panels, 650 lbs. when used vertically.
- **Mounting Options:** Horizontal, Vertical and Lock Up Mount
- **Board or Panel Materials To Use:** Solid Wood, MDF and Other Composite Materials
- **Lock Tab:** Lock tab for permanent mounting or must be sanded off or sliced off with a utility knife.

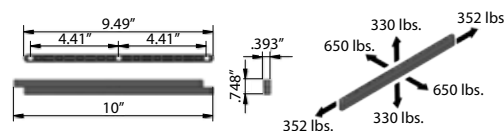

- Board Depth: 3/4"
- Projection- Recessed Mounted: Fully concealed joints
- Size of Screws: #8 x 5/8"
- # of Screws: 6 pieces
- Screw Adjustment: Yes
- 32MM Compatible

Part #	Color
SPX-MEG	Black

See Mounting Accessories Below

Accessories

Liquidlox Adhesive 20G

General purpose, middle viscosity, fast cure adhesive

Part #
SPX-ADH

Grivoly Jig Set

Adds speed to install & helps determine install of hardware

Part #	Size
SPX-P23-JIG	Pro 23
SPX-C50-JIG	Clip 50
SPX-P55-JIG	Pro 55

Router Bits

Part #	Size
SPX-7RB	7mm
SPX-10RB	10mm

▲ 7mm Router bit for Striplox Mini 60 & 120

Striplox Template

Adds speed to install & helps determine install of hardware

Part #
SPX-TEMP

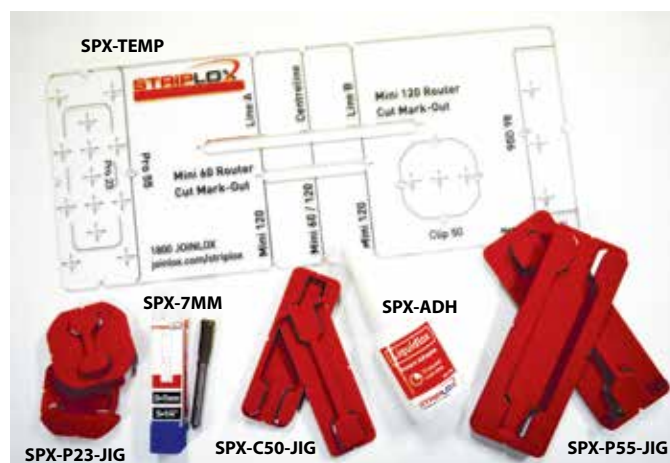

Striplox Starter Kits

43 PIECE BASIC STARTER KIT



Kit Includes:

- 4 Pcs. Striplox Pro 55
- 4 Pcs. Striplox Pro 23
- 4 Pcs. Striplox Clip 50
- 4 Pcs. Striplox 90D, 98mm White
- 4 Pcs. Striplox Mini 60mm
- 4 Pcs. Striplox Mini 120mm
- 4 Pcs. Striplox Mega-Lox
- 2 Pcs. Striplox 180D
- 10 Pcs. Striplox Griplox Biscuits
- 1 Pc. Pro 55 Jig
- 1 Pc. Clip 50 Jig
- 1 Pc. Pro 23 Jig
- 1 Carry Case

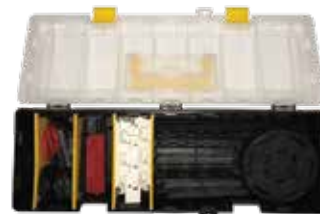

Part

SPX-SKIT-B

78 PIECE BASIC STARTER KIT



Kit Includes:

- 6 Pcs. Striplox Pro 55
- 6 Pcs. Striplox Pro 23
- 6 Pcs. Striplox Clip 50
- 6 Pcs. Striplox 90D, 98mm White
- 12 Pcs. Striplox Mini 60mm
- 6 Pcs. Striplox Mini 120mm
- 6 Pcs. Striplox Mega-Lox
- 4 Pcs. Striplox 180D
- 20 Pcs. Striplox Griplox Biscuits
- 2 Pcs. Pro 55 Jig
- 2 Pcs. Clip 50 Jig
- 2 Pcs. Pro 23 Jig
- 1 Carry Case

Part

SPX-SKIT-D



System 6: Quickfit Connectors

20mm SYSTEM 6 HOUSING

Non-Outrigger



- **MATERIAL: Nylon / Zinc**
- Works with 16mm & 19mm panels
- Drop-On application
- "Klix" locking system provides a strong, vibration proof connection
- Compatible with all screw-in and Quickfit System6 dowels
- Ideal for high volume production case goods, closets & garage storage systems
- No edge boring required
- Available in Almond **AL**, Black **BK**, Brown **BR**, Candlelight **CN**, Silver **SL** & White **WH**

AL	BK	BR	CN	SL	WH
----	----	----	----	----	----

Part #	Diameter	Type	Access	Color	Pieces Per Carton
OP6-6387-AL	19mm	Non-Outrigger	Drop-On	Almond	2500
OP6-6387-BK	19mm	Non-Outrigger	Drop-On	Black	2500
OP6-6387-BR	19mm	Non-Outrigger	Drop-On	Brown	2500
OP6-6387-CN	19mm	Non-Outrigger	Drop-On	Candlelight	2500
OP6-6387-SL	19mm	Non-Outrigger	Drop-On	Silver	2500
OP6-6387-WH	19mm	Non-Outrigger	Drop-On	White	2500
OP6-6397-AL	19mm	Outrigger	Drop-On	Almond	1250
OP6-6397-BK	19mm	Outrigger	Drop-On	Black	1250
OP6-6397-BR	19mm	Outrigger	Drop-On	Brown	1250
OP6-6397-SL	19mm	Outrigger	Drop-On	Silver	1250
OP6-6397-WH	19mm	Outrigger	Drop-On	White	1250
OP6-6431-CN	16mm	Non-Outrigger	Drop-On	Candlelight	2500
OP6-6431-WH	16mm	Non-Outrigger	Drop-On	White	2500
OP6-6435-AL	16mm	Non-Outrigger	Side Entry	Almond	2500
OP6-6435-BK	16mm	Non-Outrigger	Side Entry	Black	2500
OP6-6435-BR	16mm	Non-Outrigger	Side Entry	Brown	2500
OP6-6435-WH	16mm	Non-Outrigger	Side Entry	White	2500
OP6-6437-BK	19mm	Non-Outrigger	Side Entry	Black	2500
OP6-6437-BR	19mm	Non-Outrigger	Side Entry	Brown	2500
OP6-6437-CN	19mm	Non-Outrigger	Side Entry	Candlelight	2500
OP6-6437-WH	19mm	Non-Outrigger	Side Entry	White	2500
OP6-6439-AL	16mm	Outrigger	Drop-On	Almond	1250
OP6-6439-CN	16mm	Outrigger	Drop-On	Candlelight	1250

Outrigger

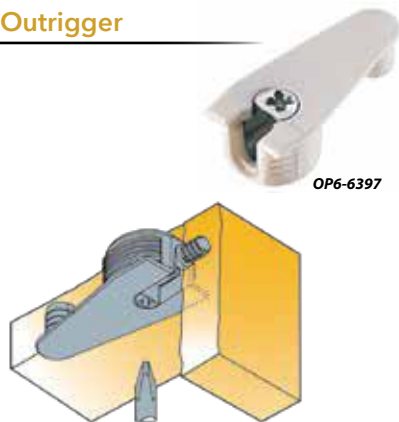

System 6: Quickfit Dowels

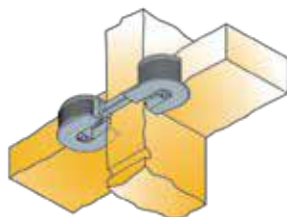

- Zinc construction
- For panel-to-panel and back-to-back applications
- Works with all System 6 housing
- Depth stop collar for accurate insertion



Part #	Drill Length For Dowel Thread	Finish	Pieces Per Carton
OPHS-6402	(8mm) 0.315"	Zinc	5000
OPHS-6406	(11.5mm) 0.45"	Zinc	5000

Double Ended Dowel



Part #	Finish	Pieces Per Carton
OP6-6416	Zinc	1000

Expandable Dowel

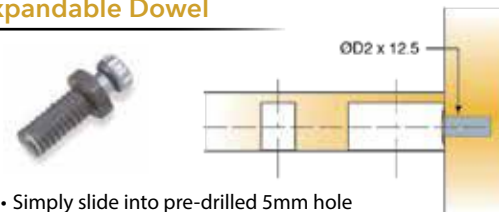

- Simply slide into pre-drilled 5mm hole
- The dowel expands in the hole as the housing cam is rotated
- Can quickly and easily be moved to a different location without damaging panels

Part #	Finish	Pieces Per Carton
OP6-6408	Zinc	5000

System 5: Cam & Dowels

15mm Cam

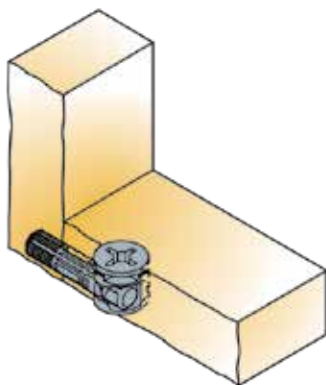

- Zinc construction (OP5-5644B: Zinc/Nylon)
- For 15/16mm & 18/19mm panel thickness
- "Klix" locking feature provides a strong vibration proof connection
- Linear cam profile results in smooth easy cam rotation & dowel pull out

Part #	Panel Thickness	Drilling Depth	Finish	Pieces Per Carton
OP5-5644B	15/16mm	(12mm) 0.50"	Black	2000
OP5-5644Z	15/16mm	(12mm) 0.50"	Zinc	2000
OP5-5656Z	18/19mm	(14mm) 0.55"	Zinc	2000

Combi Dowel



- Zinc /Steel construction
- Greater resistance to torsion and pull out
- "Klix" locking feature provides a strong vibration proof connection
- Twinstart thread for faster and reliable insertion
- Suitable for use with all 12mm & 15mm cams

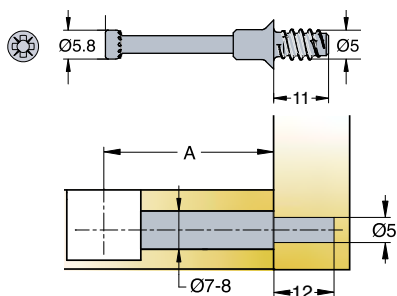

Part #	Thread Length	Drilling Depth	Drilling Distance [A]	Finish	Pieces Per Carton
OP5-9423Z	(11mm) 0.433"	(12mm) 0.472"	(24mm) 0.945"	Zinc	2000
OP5-9424Z	(11mm) 0.433"	(12mm) 0.472"	(34mm) 1.339"	Zinc	2000

System 4: Quickloc



- Zinc construction
- For use with 5/8" and 3/4" panels
- **Drill Size: Cam:** 25mm, **Dowel:** 10mm
- **Drilling Depth: Cam:** 11mm, **Dowel:** 13mm

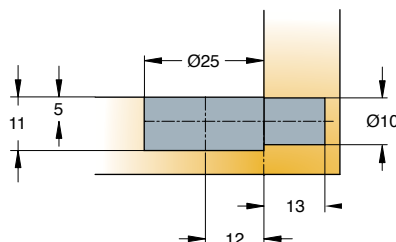
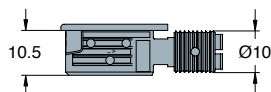

- One piece expanding connector
- Capable of hand insertion
- Highly tolerant and tightens in less than one turn
- Face boring product with high degree of drilling tolerance
- Only connector to provide pull-up of cabinet panels when tightened

Part #	Finish	Pieces Per Carton
OP4-6802-BK	Black	1500
OP4-6802-DB	Dark Brown	1500
OP4-6802-WH	White	1500

System 3: Fasteners for Face & Edge Boring

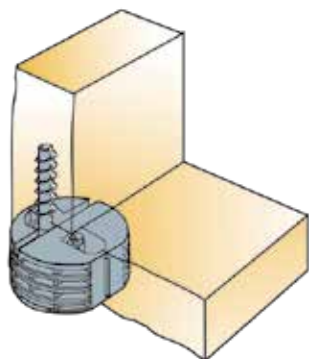

Housing Assembly



Screw Dowels



- 2-Component, 1-Turn lock system
- Pre-assembled for consumer convenience
- (1") 25mm dia. housing x (1/2") 12.5mm depth
- Choice of dowels to suit drilling
- Hi-Lo screw feature for faster insertion

Part #	Description	Finish	Material	Pieces Per Carton
OPHS-3118	Housing	White	Nylon	2500
OP-3118BR	Housing	Brown	Nylon	2500

Part #	Description	Finish	Material	Pieces Per Carton
OPHS-3165	Euro Screw Dowel	Zinc	Steel	1000

Furniture Dowels

Modesty Block Dowels

Material: Polyethylene

- Moisture Resistant
- No glue necessary
- Self Locking

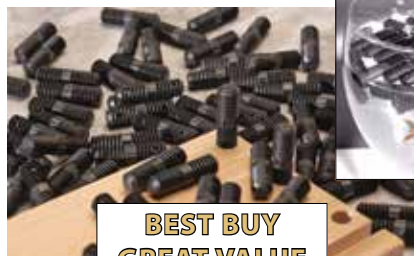

**BEST BUY
GREAT VALUE**

Part #	Size	Color
R25-830	8mm x 30mm	Black

Furniture Joiner Hardware

Material: Nylon*

For joints stronger than the wood or wood product itself

- Reduces assembly time
- Insert manually or with most doweling machines
- Not affected by humidity - less likely to jam insertion equipment
- Forced fit - no glue necessary

**ELIMINATES GLUING
& CLAMPING**



PREMIUM SERIES



Part #	Diameter x Length	Color
*R25-147	6mm x 1-1/8"	Natural
R25-604	8mm x 1-1/2"	Natural
R25-860	8mm x 1-1/2"	Natural

* 33% Glass Filled Nylon

Window Shutter Pins

Standard Shutter Pin

Material: Nylon

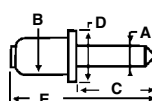

A = Pin Diameter: .014"
B = Head Diameter: .242"
C = Pin Length: .676"
D = Shoulder Diameter: .306"
E = Full Length: 1.076"

Part #	Color
SP-1	Natural

Retractable Shutter Pin

Material: Polyethylene

- Great for replacements & repairs

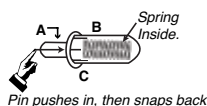

A = Pin Diameter: .014"
B = Head Diameter: .24"
C = Full Length: .875"

Part #	Color
SP-17	White

Tension Control Shutter Pin

Material: Nylon

- Cuts down on loose slats

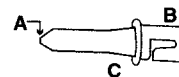

A = Pin Diameter: .014"
B = Head Diameter: .24"
C = Full Length: 1.08"
Spring Diameter: 0.255"

- For 2-1/2" louver, use every 3rd slat
- For 3-1/2" louver, use every 2nd slat
- For 4-1/2" louver, use every slat

Part #	Color
SP-19	Natural

• White Birch • *Available Fluted or Spiral

(*Please Specify Fluted or Spiral When Ordering)

• Kiln Dried To 6-8% Moisture

Which pin is better, Spiral or Fluted? There is no real answer as to which pin offers better holding power. While some manufacturers dowel-inserting machinery may advise which groove suits its machinery better, both pins offer excellent dispersion of glue as well as excellent bonding qualities.

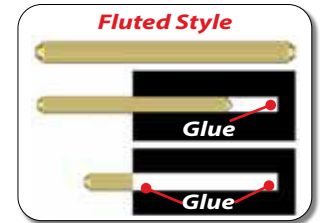

SIZE: 1/4" x 1" (*Fluted or Spiral)			
PART #	R25-2510C*	R25-2510M*	R25-2510B-*BX (Bulk)
QUANTITY	100 Pcs./Bag	1,000 Pcs./Bag	38,700 Pcs.

SIZE: 7/16" x 2" (*Fluted or Spiral)			
PART #	R25-4320C*	R25-4320M*	R25-4320B-*BX (Bulk)
QUANTITY	100 Pcs./Bag	1,000 Pcs./Bag	10,000 Pcs.

SIZE: 1/4" x 1-1/2" (*Fluted or Spiral)			
PART #	R25-2515C*	R25-2515M*	R25-2515B-*BX (Bulk)
QUANTITY	100 Pcs./Bag	1,000 Pcs./Bag	24,000 Pcs.

SIZE: 7/16" x 2-1/2" (*Fluted or Spiral)			
PART #	R25-4325C*	R25-4325M*	R25-4325B-*BX (Bulk)
QUANTITY	100 Pcs./Bag	1,000 Pcs./Bag	8,500 Pcs.

SIZE: 1/4" x 1-3/4" (*Fluted or Spiral)			
PART #	R25-2517C*	R25-2517M*	R25-2517B-*BX (Bulk)
QUANTITY	100 Pcs./Bag	1,000 Pcs./Bag	21,000 Pcs.

SIZE: 7/16" x 3" (*Fluted or Spiral)			
PART #	R25-4330C*	R25-4330M*	R25-4330B-*BX (Bulk)
QUANTITY	100 Pcs./Bag	1,000 Pcs./Bag	7,000 Pcs.

SIZE: 1/4" x 2" (*Fluted or Spiral)			
PART #	R25-2520C*	R25-2520M*	R25-2520B-*BX (Bulk)
QUANTITY	100 Pcs./Bag	1,000 Pcs./Bag	18,000 Pcs.

SIZE: 1/2" x 2" (*Fluted or Spiral)			
PART #	R25-5020C*	R25-5020M*	R25-5020B-*BX (Bulk)
QUANTITY	100 Pcs./Bag	1,000 Pcs./Bag	8,000 Pcs.

SIZE: 3/8" x 1" (*Fluted or Spiral)			
PART #	R25-3710C*	R25-3710M*	R25-3710B-*BX (Bulk)
QUANTITY	100 Pcs./Bag	1,000 Pcs./Bag	25,000 Pcs.

SIZE: 1/2" x 2-1/2" (*Fluted or Spiral)			
PART #	R25-5025C*	R25-5025M*	R25-5025B-*BX (Bulk)
QUANTITY	100 Pcs./Bag	1,000 Pcs./Bag	6,000 Pcs.

SIZE: 3/8" x 1-1/4" (*Fluted or Spiral)			
PART #	R25-3712C*	R25-3712M*	R25-3712B-*BX (Bulk)
QUANTITY	100 Pcs./Bag	1,000 Pcs./Bag	23,000 Pcs.

SIZE: 1/2" x 3" (*Fluted or Spiral)			
PART #	R25-5030C*	R25-5030M*	R25-5030B-*BX (Bulk)
QUANTITY	100 Pcs./Bag	1,000 Pcs./Bag	5,000 Pcs.

SIZE: 3/8" x 1-1/2" (*Fluted or Spiral)			
PART #	R25-3715C*	R25-3715M*	R25-3715B-*BX (Bulk)
QUANTITY	100 Pcs./Bag	1,000 Pcs./Bag	20,000 Pcs.

METRIC SIZES			
SIZE: 6mm x 25mm (*Fluted or Spiral)			
PART #	R25-6250C*	R25-6250M*	R25-6250B-*BX (Bulk)
QUANTITY	100 Pcs./Bag	1,000 Pcs./Bag	44,000 Pcs.

SIZE: 3/8" x 1-3/4" (*Fluted or Spiral)			
PART #	R25-3717C*	R25-3717M*	R25-3717B-*BX (Bulk)
QUANTITY	100 Pcs./Bag	1,000 Pcs./Bag	16,000 Pcs.

SIZE: 6mm x 30mm (*Fluted or Spiral)			
PART #	R25-6300C*	R25-6300M*	R25-6300B-*BX (Bulk)
QUANTITY	100 Pcs./Bag	1,000 Pcs./Bag	35,400 Pcs.

SIZE: 3/8" x 2" (*Fluted or Spiral)			
PART #	R25-3720C*	R25-3720M*	R25-3720B-*BX (Bulk)
QUANTITY	100 Pcs./Bag	1,000 Pcs./Bag	13,000 Pcs.

SIZE: 8mm x 30mm (*Fluted or Spiral)			
PART #	R25-8300C*	R25-8300M*	R25-8300B-*BX (Bulk)
QUANTITY	100 Pcs./Bag	1,000 Pcs./Bag	19,200 Pcs.

SIZE: 3/8" x 2-1/2" (*Fluted or Spiral)			
PART #	R25-3725C*	R25-3725M*	R25-3725B-*BX (Bulk)
QUANTITY	100 Pcs./Bag	1,000 Pcs./Bag	10,000 Pcs.

SIZE: 8mm x 32mm (*Fluted or Spiral)			
PART #	R25-8320C*	R25-8320M*	R25-8320B-*BX (Bulk)
QUANTITY	100 Pcs./Bag	1,000 Pcs./Bag	20,000 Pcs.

SIZE: 7/16" x 1-1/2" (*Fluted or Spiral)			
PART #	R25-4315C*	R25-4315M*	R25-4315B-*BX (Bulk)
QUANTITY	100 Pcs./Bag	1,000 Pcs./Bag	15,000 Pcs.

SIZE: 8mm x 35mm (*Fluted or Spiral)			
PART #	R25-8350C*	R25-8350M*	R25-8350B-*BX (Bulk)
QUANTITY	100 Pcs./Bag	1,000 Pcs./Bag	20,000 Pcs.

SIZE: 7/16" x 1-3/4" (*Fluted or Spiral)			
PART #	R25-4317C*	R25-4317M*	R25-4317B-*BX (Bulk)
QUANTITY	100 Pcs./Bag	1,000 Pcs./Bag	12,000 Pcs.

Plastic Cabinet Components

CORNER PROTECTORS

- Designed to protect vulnerable corners of mirrors, cabinet doors and picture frames.

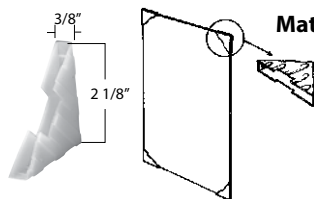

Material: HDPE

For 3/16" or 1/4" Glass

Part #	Color
GC-215	White

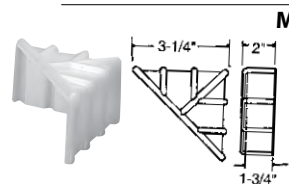

Material: HDPE

Part #	Color
CP-448	White



Material: Polyethylene

Accepts Up To 1/2" Thick Material

Part #	Color
GC-500	White

CORNER BLOCK WITH BARB NUT

5/16-18 Thread • Black



R44N-952BK



R44BN-952-BK

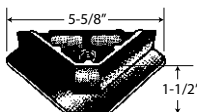

Part #	Material	Barb Nut Placement
R44N-952BK	Nylon	Top
R44BN-952BK	Nylon - reversed thread	Underside

GLUE AND STAPLE BLOCKS

Material: Polyethylene

- Stapled inside the cabinet to hold the cabinet backs and sides together during the assembly process.

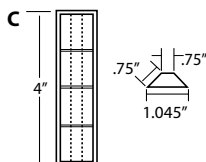
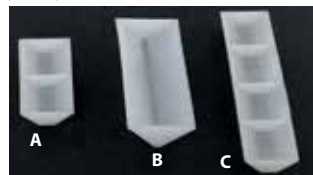
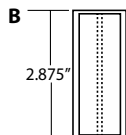
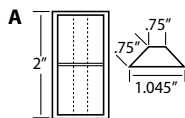

	Part #	Color	Size
A	R44-250	White	2"
B	R44-300	White	3"
C	R44-400	White	4"

CORNER BRACES

- Designed to strengthen and stabilize the cabinet during the manufacturing process.
- To be installed in the top section of the base cabinet and aid in securing the countertop.

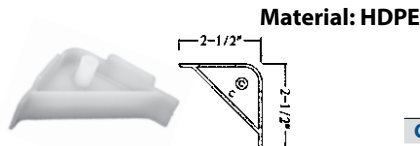

Material: HDPE

Part #	Color
CB-2500	White



Material: Polyethylene

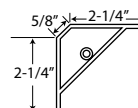

Part #	Color
CB-920	White

PLASTIC WEDGE & DOOR STOP

Material: HDPE

- Wedges are used to assure proper positioning of hinged doors
- Wedges guide doors when case is out of alignment
- Neat appearance, assures doors stay closed, economical & does not require finishing.
- May be installed at top or bottom of all doors, side of single doors.

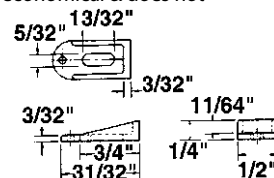

Part #	Color
R50-441DBR	Dark Brown
R50-441WH	White

BREAK-AWAY PLASTIC FURNITURE WEDGE

Material: Polystyrene

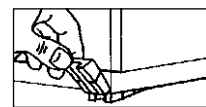
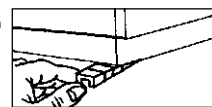
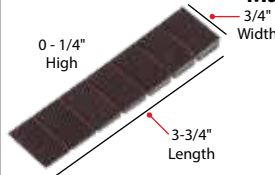

Part #	Color
58-076-400	Dark Brown

FLOOR GLIDE AND PROTECTOR

Material: Polyethylene

- Staple to underside of cabinets or furniture
- Prevents damage to cabinets during handling and transportation.
- 1/4" (60mm) of clearance between cabinet and floor

Part #	Color	Size
R32-737	Natural	1-1/2"



REACH & ROHS
COMPLIANT

RATCHET ASSEMBLY POST & SCREW

- Polypropylene
- Simply press together these screws with serrated pins for fast and easy assembly
- Works with flat panels, punched papers, key cases, catalogs, etc.
- Not intended for applications requiring removable/reusable fasteners!
- Usable in corrosive environments
- Will not mark or mar most surfaces

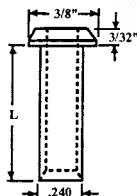

Part #	Color	Length
SP-250BK	Black	1/4"
SP-375BK	Black	3/8"
SP-375WH	White	3/8"
SP-500WH	White	1/2"
SP-750BK	Black	3/4"
SP-750WH	White	3/4"

REACH & ROHS
COMPLIANT

Natural Nylon Arrow Clips

- Natural Nylon is off-white in color
- Molded natural nylon fasteners offer an inexpensive fast method to hand assemble metal, wood and plastic composition or any other thin gauge materials.
- Reusable
- Specially designed body compresses through a pre-punched hole and springs back to shape, locking the assembled parts securely.
- Provides a vibration, abrasion and corrosion resistant connection.
- Electrically insulating

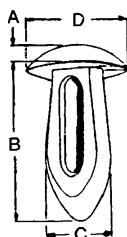
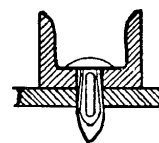
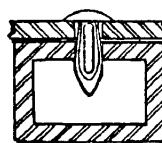

Part #	Hole Size	Panel Thickness Range	Head Dia. 'D'	Head Height 'A'	Length 'B'	Clip Dia. 'C'
AC-001	.182/.192	.062/.125	.360	.060	.400	.225
AC-003	.151/.161	.062/.125	.280	.040	.390	.196
AC-006	.182/.192	.310/.330	.370	.060	.540	.225
AC-009	.250/.260	.125/.187	.484	.060	.575	.290
AC-015	.118/.122	.062/.125	.280	.060	.390	.150
AC-016	.250/.260	.360/.380	.610	.065	.810	.286

OTHER SIZES AVAILABLE - PLEASE INQUIRE

REACH & ROHS
COMPLIANT

Plastic Fasteners

CANOE FASTENERS

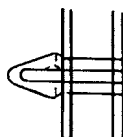
Material: Celcon
Black & White

Part #	Color	Hole Size	Shaft	Head Dia.	Work Thickness
PF6-20BK	Black	3/16"	5/8"	13/32"	.228
PF6-20WH	White	3/16"	5/8"	13/32"	.228
PF6-31BK	Black	3/16"	5/8"	27/64"	.325
PF6-31WH	White	3/16"	5/8"	27/64"	.325

ROW BOAT FASTENERS

Material: HDPE
Black & White

- Fits hole size 1/4"
- Fits work thickness 1/4"
- Overall Length: .687"



Part #	Color
CF8-20BK	Black
CF8-20WH	White

TREE FASTENERS

Material: Nylon
Black, White & Gray

Used for one-time applications & is purposely difficult to remove

PF8-16BK



PF8-24BK



Part #	Color	Hole Size	Shaft	Head Dia.	Work Thickness
PF8-16BK	Black	1/4"	1/2"	11/16"	.180-.220
PF8-16WH	White	1/4"	1/2"	11/16"	.180-.220
PF8-20BK	Black	1/4"	5/8"	11/16"	.180-.380
PF8-20WH	White	1/4"	5/8"	11/16"	.180-.380
PF8-20GY	Gray	1/4"	5/8"	11/16"	.180-.380
PF8-24BK	Black	1/4"	3/4"	11/16"	.180-.570
PF8-28BK	Black	1/4"	7/8"	11/16"	.180-.700
PF8-32BK	Black	1/4"	1"	11/16"	.180-.820

Table Connector

Material: Steel & Plastic Construction

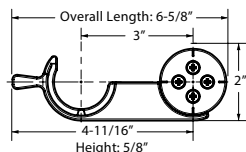

2 pieces required for connection

Part#	Color
CN-4790	Black

**REQUIRED: #6 Panhead Screws
(4 screws per connector)
SCR-6100PHZ
Zinc Finish • #6 x 1"**



Turn to secure connectors



Snaps to lock in place

Modular Furniture Connector

Material: Nylon

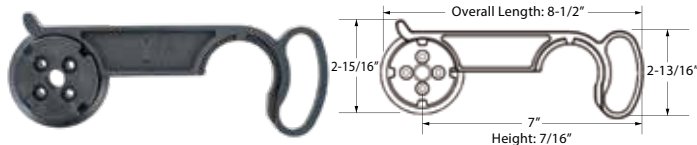

2 pieces required for connection

Part#	Color
CN-4792	Black

**REQUIRED: #8 Panhead Screws
(4 screws per connector)
SCR-8125PHZ
Zinc Finish • #8 x 1-1/4"**

Ideal for any communal seating area in residential, commercial or educational settings.



Modular Furniture

Table Aligners

Material: HDPE



Part#	Color
CN-01	Brown

**#8 Flathead Screws
SCR-8625FHZ
Zinc Finish • #8 x 5/8"**

Material: Steel



Part #
H-3

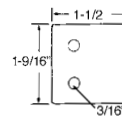

Application On Table Underside:

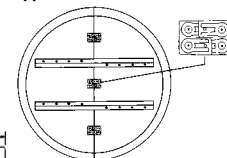

**#10 Panhead Screws
SCR-1625PHZ
Zinc Finish • #10 x 5/8"**

Flip Bolt Connector

Material: Steel



Flip the arm to lock in place

Part #	Size
FC-FB	4-1/2"

Black

(White where noted)

Sponge Rubber

Recommended Temperature
Range for General
Product Applications
-20° through +150°

MANY APPLICATIONS:

Cabinets
Doors
Windows
Camper Shell Doors
Skylights
Sunroofs
and many others

114-113 (Black only)

500 Ft. Coils w/Adhesive

114-1033 (Black only)

500 Ft. Coils w/Adhesive

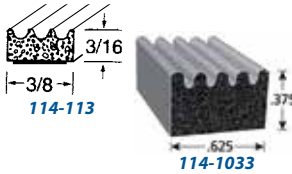

114-114 (Black only)

500 Ft. Coils w/Adhesive

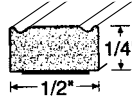

114-1333 (Black)

500 Ft. Coils w/Adhesive

114-1333-OW (Off White)

500 Ft. Coils w/Adhesive

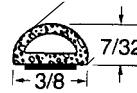

114-119 (Black only)

500 Ft. Coils w/Adhesive

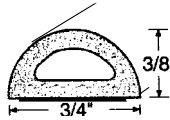

115-500D

Black 3/8" D-Shape
EPMD Foam Seal
w/Bonded 3M Adhesive
500 Ft. Coils



115-750D

Black 3/4" D-Shape
EPMD Foam Seal
w/Bonded 3M Adhesive
200 Ft. Coils

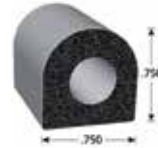

P-SEAL

Black 1/2" x 1-1/4" P-Shape
Rubber Seal
w/High Temp Adhesive
250 Ft. Coils

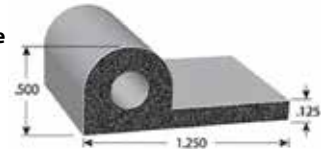

DR-1-*

Black (*BK), White (*WH), Brown (*BR)
PVC - 8 Ft. Lengths



5mm Adhesive Tape

APPLICATION:
DR-1,
DR-6,

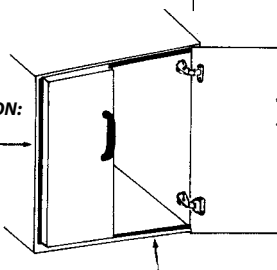

DR-6-*

White (*WH), Almond (*AL)
Polypropylene w/Santoprene
1000 Ft. Coils

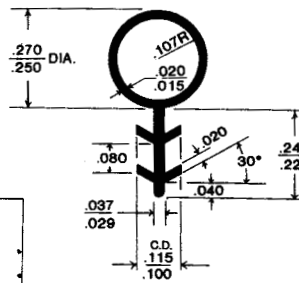

DR-2-*

Black (*BK), White (*WH), Brown (*BR),
Clear (*CL), Almond (*AL)
Dual Durometer/PVC - 8 Ft. Lengths

APPLICATION

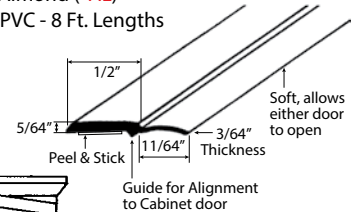
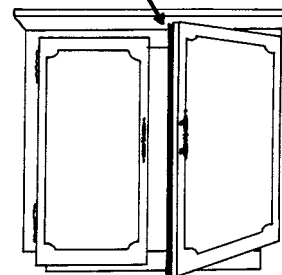

Guide for Alignment
to Cabinet door

Ultra Pile Dust Seal / Weatherseal with Adhesive

Lengths: 50 Ft. Coils • Color: Gray

Self supporting pile is
always on center and has the
integrity and consistency
to ensure a tight seal

MANY APPLICATIONS:

Windows
Doors
Showcases

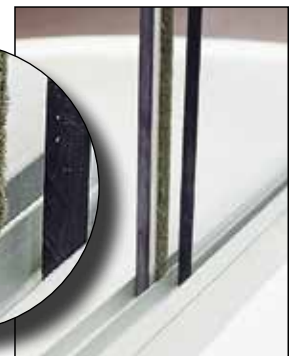

Part#	Description
DS-150-GY	.270 W x .150 H
DS-200-GY	.270 W x .200 H

7" FLAT OR 3-D

THIS IS OUR MOST POPULAR AND VARIED LINE OF SWIVELS.

7" SQUARE PLATES HAVE SLOTS ON 5-1/4" CENTERS. 12 GAUGE STEEL. PITCH AVAILABLE IN FLAT, 3°.

NOTE: FLAT SWIVELS ARE FOR CHAIRS WITHOUT BACKS, 3-D SWIVELS ARE FOR CHAIRS WITH BACKS.

**Top & Bottom Plates,
5-1/4" Slotted Centers**
7 Square Plate
12 Gauge Steel
Pieces Per Carton: 16



**Standard Swivel Used On Entire Trendler Pedestal Base Line.
May Be Used In Conjunction With 3-1/4" Weld Plates.
Four 1/4"-20 Threaded Holes On 2-1/2" Centers.**

Pieces Per Carton: 25

Weight Each: 2.50 Lbs.

TRB3 (FLAT)

ALSO AVAILABLE 3-1/4" WELD PLATE:

TP325

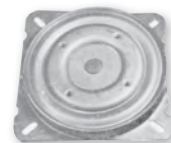

T712F (FLAT)

T712 (3-D)

Revolving Turntables

STEEL LAZY SUSANS

- Only 5/16" Thick (Can be recessed into surfaces for 1/8" thickness).
- Large, Full Ball Race For Maximum Stability & Smooth Gliding Rotation.
- 360° Interlock Prevents Separation.
- Electro Zinc Coated For Rust Resistance.
- Orders for less than the carton quantity are subject to a broken box fee.
- Made in the USA.

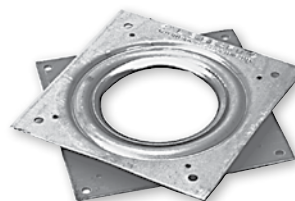

Part #	Size	Center Hole Dia.	Weight Capacity	Approx. Top Dia.	Carton Quantity
S8-300C	3" Sq.	1-1/4"	200 lbs.	Up to 18"	100
S8-400C	4" Sq.	2-5/32"	300 lbs.	12" - 25"	100
S8-600C	6" Sq.	4-11/16"	500 lbs.	15" - 30"	100
S8-900C	9" Dia.	4-1/2"	700 lbs.	17" - 35"	25
S8-1200C	12" Dia.	6-9/32"	1000 lbs.	20" & Over	25

ALUMINUM LAZY SUSANS

LOW NOISE

- Countersunk holes for flush mounting
- Screw hole diameter is 3/16", use #8 screw
- Plastic feet on both sides of turntable
- **Low Noise:** Patented Technology provides less noise than traditional swivels and provides a smooth and quiet glide with every turn!



Top View



Bottom View

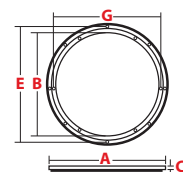

Part #	Diameter		Height C	Load Rating	Outer			Inner		
	Outside A	Inside B			Center to Center E	Thru Holes	Pads	Center to Center G	Thru Holes	Pads
S8L-1200C	12"	10"	9/16"	265 lbs.	11"	0	6	10"	3	6
S8L-1600C	16"	13"	9/16"	350 lbs.	15"	0	6	14"	3	6
S8L-1800C	18"	15"	9/16"	395 lbs.	16"	4	8	15"	6	6
S8L-2400C	24"	21"	5/8"	485 lbs.	23"	0	10	21"	4	8

• **COLOR - BLACK**

- Constructed of durable nylon or polypropylene knobs with zinc plated steel studs and inserts
- Designed for economical, light-duty securing and clamping applications
- Resistant to water and solvents



Style	Part #	Diameter	Thread Size	Type	Stud Length	Material
1	S7-F10BK	1.575"	5/16-18	Female	N/A	Polypropylene
	S7-F15BK	2.36"	5/16-18	Female	N/A	Polypropylene
	S7-F14BK	1.575"	1/4-20	Male	1.375"	Polypropylene
	S7-F17BK	1.575"	5/16-18	Male	.50"	Polypropylene
	S7-F18BK	1.575"	5/16-18	Male	.75"	Polypropylene
	S7-F19BK	1.575"	5/16-18	Male	1.375"	Polypropylene
	S7-F20BK	2.36"	5/16-18	Male	.50"	Polypropylene
	S7-F21BK	2.36"	5/16-18	Male	.75"	Polypropylene
2	S7-N12BK	1.575"	1/4-20	Female	N/A	Polypropylene
	S7-N13BK	2.36"	5/16-18	Female	N/A	Polypropylene
	S7-N22BK	1.575"	1/4-20	Male	.75"	Polypropylene
	S7-N23BK	1.575"	1/4-20	Male	1.375"	Polypropylene
	S7-N24BK	1.575"	5/16-18	Male	.50"	Polypropylene
	S7-N25BK	1.575"	5/16-18	Male	.75"	Polypropylene
	S7-N26BK	1.575"	5/16-18	Male	1.00"	Polypropylene
	S7-N27BK	1.575"	5/16-18	Male	1.375"	Polypropylene
3	S7-N28BK	2.36"	5/16-18	Male	.75"	Polypropylene
	S7-N29BK	2.36"	5/16-18	Male	1.50"	Polypropylene
	S7-K14BK	1.575"	5/16-18	Female	N/A	Polypropylene
	S7-K15BK	2.36"	5/16-18	Female	N/A	Polypropylene
	S7-A30BK	1.575"	1/4-20	Male	.75"	Polypropylene
	S7-A31BK	1.575"	1/4-20	Male	1.375"	Polypropylene
	S7-A32BK	1.575"	5/16-18	Male	.75"	Polypropylene
	S7-A33BK	1.575"	5/16-18	Male	.50"	Polypropylene
4	S7-A35BK	1.575"	5/16-18	Male	1.50"	Polypropylene
	S7-A36BK	2.36"	5/16-18	Male	.75"	Polypropylene
	S7-A37BK	2.36"	5/16-18	Male	1.50"	Polypropylene
	S7-I31BK	2.50"	1/4-20	Female	N/A	Nylon
5	S7-J21BK	1.375"	1/4-20	Male	.75"	Nylon



2P10 ADHESIVE KIT

2P-10 is a two-part ten-second adhesive. Just apply the adhesive, then spray the activator and stick it together for a strong permanent bond. Its greatest benefits are its speed and strength.

Kit Includes:

- (1) 2.25 oz. Thin for filling micro cracks
- (1) 2.25 oz. Medium for use on smooth surfaces such as laminate
- (1) 2.25 oz. Thick for use on porous surfaces such as particle board
- (1) 2.25 oz. Jel all purpose application. Will not run on vertical surfaces
- (1) 2 oz. Activator
- (1) 2 oz. Adhesive debonder
- (5) Mirco tips
- (2) Brushes
- (1) Pump spray top



2P-10-KIT



GLU-BOT

16 OZ. GLUE BOTTLE

The Glübot™ is designed with a 2-chamber system that pushes glue from the bottom up through the secondary side chamber which ensures fresh glue every time.

- Replaceable tips and cap storage
- Dispenses glue from the bottom first
- Includes: 1 Blade Tip, 1 Yorker Tip, 1 Red Cap

Great for...Yellow glue, wood glue and other liquids



2P10-SOLO-ACT

2P10 ADHESIVE ACTIVATOR

12 oz. aerosol can of adhesive activator produces a ten-second bond time when used with 2P-10 adhesives.

3M™ Flexible Adhesive



30 NF FASTBOND™ CONTACT ADHESIVE, GREEN (PROTECT FROM FREEZING)

Fastbond™ brand adhesives are industrial-quality products designed to provide innovative answers to a wide variety of non-structural bonding problems. (TECHNICAL INFO AVAILABLE UPON REQUEST)

A water dispersed high strength contact adhesive that changes color from blue to green when dry. Has high coverage, a long bonding range and good heat resistance. Can be used to bond foamed plastics, plastic laminate, wood, plywood and wood veneer, and canvas to themselves and each other, as well as for postforming operations. Meets requirements of MIL-A-24179-A. Non-flammable in the wet state.

Part #	Size	Case Quantity
4276-Q	Quart	12
4276-G	Gallon	4
4276-P	5 Gallon Pail	-

POLYETHYLENE FOAM TAPE



ROLLS

Available 1/32" or 1/16" thick
 - 1/2", 3/4" or 1" Wide
 - White or Black
 - 216 Ft. Rolls

1/32" THICK

Part #	Width
RFT1-0500-	1/2"
RFT1-0750-	3/4"
RFT1-1000-	1"

1/16" THICK

Part #	Width
RFT2-0500-WH	1/2"
RFT2-0750-WH	3/4"
RFT2-1000-WH	1"

ROUND DOTS

Available 1/32" or 1/16" thick
 - 1/2", 3/4" or 1" Wide
 - White Only

1/32" THICK

Part #	Dia.
RFT1-120	1/2"
RFT1-340	3/4"
RFT1-100	1"



1/16" THICK

Part #	Dia.
RFT2-120	1/2"
RFT2-340	3/4"
RFT2-100	1"

SQUARE DOTS

Available 1/32" thick
 - 1/2", 3/4" or 1" Wide
 - White Only

1/32" THICK

Part #	Sq.
RFT1-SQ120-100	1/2"
RFT1-SQ340-100	3/4"
RFT1-SQ100-100	1"

CLEAR FILM TAPE

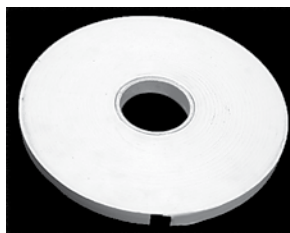

- .5mil polyester film with 2mil adhesive
- Rubber based adhesive not recommended for direct UV exposure applications.
- Application temperature: 65°F-100°F
- Service temperature: -20°F-150°F
- Roll core: 3" Diameter - 180 Ft.

Part # Width

DK-0500	1/2"
DK-0750	3/4"
DK-1000	1"

Acrylic Based Foam Tape



• Double Stick • White
 1/32" thick • 3/8" Wide • 216 Ft. Rolls

Part # Width

AFT1-0375-WH	3/8"
---------------------	------

Adhesive Blocks

PERMANENT ADHESIVE BOTH SIDES

- Rubber based adhesive
- Works on a variety of surfaces
- Helps signage stand out with 3D effects
- For light-weight applications or filling gaps

Part #	Size	Color	Pad Qty.	Box Qty.
RFTB-501010	1/2" x 1" x 1"	White	12	2400
RFTB-757510	3/4" x 3/4" x 1"	White	24	2400
RFTB-101010	1" x 1" x 1"	White	36	2520

REMOVABLE ADHESIVE ONE SIDE, PERMANENT ADHESIVE ONE SIDE

Part #	Size	Color	Pad Qty.	Box Qty.
NPAB-1-501010	1/2" x 1" x 1"	White	12	2400
NPAB-1-101010	1" x 1" x 1"	White	36	6012

REMOVABLE ADHESIVE BOTH SIDES

- Helps create 3D effects for your graphics
- Works with graphics in traveling exhibit booths
- Easily removable from most hard surfaces with no residue
- Good for temporary signage and displays
- Can be used as protective packaging

Part #	Size	Color	Pad Qty.	Box Qty.
NPAB-2-101010	1" x 1" x 1"	White	N/A	6012



Removable Tapes

REMOVABLE ONE SIDE, PERMANENT ONE SIDE

- Removable side leaves no residue on most hard surfaces
- Good for single use graphics

Part #	Size	Color	Coil Size
NPA1-1-0500	1/2" W x 1/32" T	White	216 ft.
NPA2-1-0500-BK	1/2" W x 1/16" T	Black	216 ft.

REMOVABLE TWO SIDES

- Removable side leaves no residue on most hard surfaces
- Allows graphics to be used multiple times with no damage

Part #	Size	Color	Coil Size
NPA-1-2-0500	1/2" W x 1/32" T	White	216 ft.
NPA-1-2-0500-BK	1/2" W x 1/32" T	Black	216 ft.

CLEAR REMOVABLE TAPE

- For use with glass, acrylic, polycarbonate, and more
- Removable side leaves no residue on most hard surfaces
- Allows graphics to be used multiple times with no damage

Part #	Size	Color	Coil Size
NPA1-2-0500-CL	1/2" W x 1/32" T	Clear	216 ft.

REMOVABLE TAPE FOR METAL SHELVING

- Adhesive comes off metal shelves with no residue
- Change campaigns, change the shelf edge

Part #	Size	Color	Coil Size
MST1-1-0500	1/2" W x 1/32" T	White	216 ft.